

Locality Diagram

Not to Scale

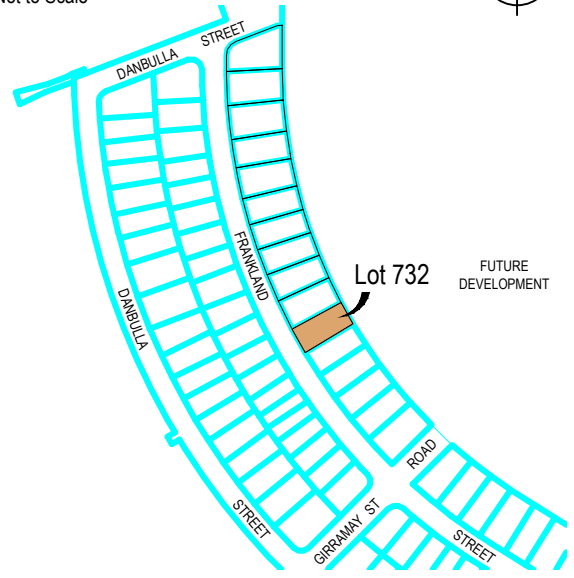

Legend

- Proposed Fence
- Proposed Change of Grade
- Fill Depth Contour
- Proposed Surface Contour
- Retaining Wall
- Proposed Surface Level
- Height of Wall HW 1.6m
- Average Height of Wall AWH 1.4m

- Depth of Fill 0.0m-0.5m
- Depth of Fill 0.5m-1.0m
- Depth of Fill 1.0m-1.5m
- Depth of Fill 1.5m-2.0m
- Depth of Fill 2.0m-2.5m
- Depth of Fill 2.5m-3.0m
- Depth of Fill 3.0m-3.5m
- Depth of Fill 3.5m-4.0m
- Depth of Fill 4.0m-4.5m
- Depth of Fill 4.5m-5.0m
- Depth of Fill 5.0m-5.5m
- Depth of Fill 5.5m-6.0m
- Depth of Fill 6.0m-6.5m

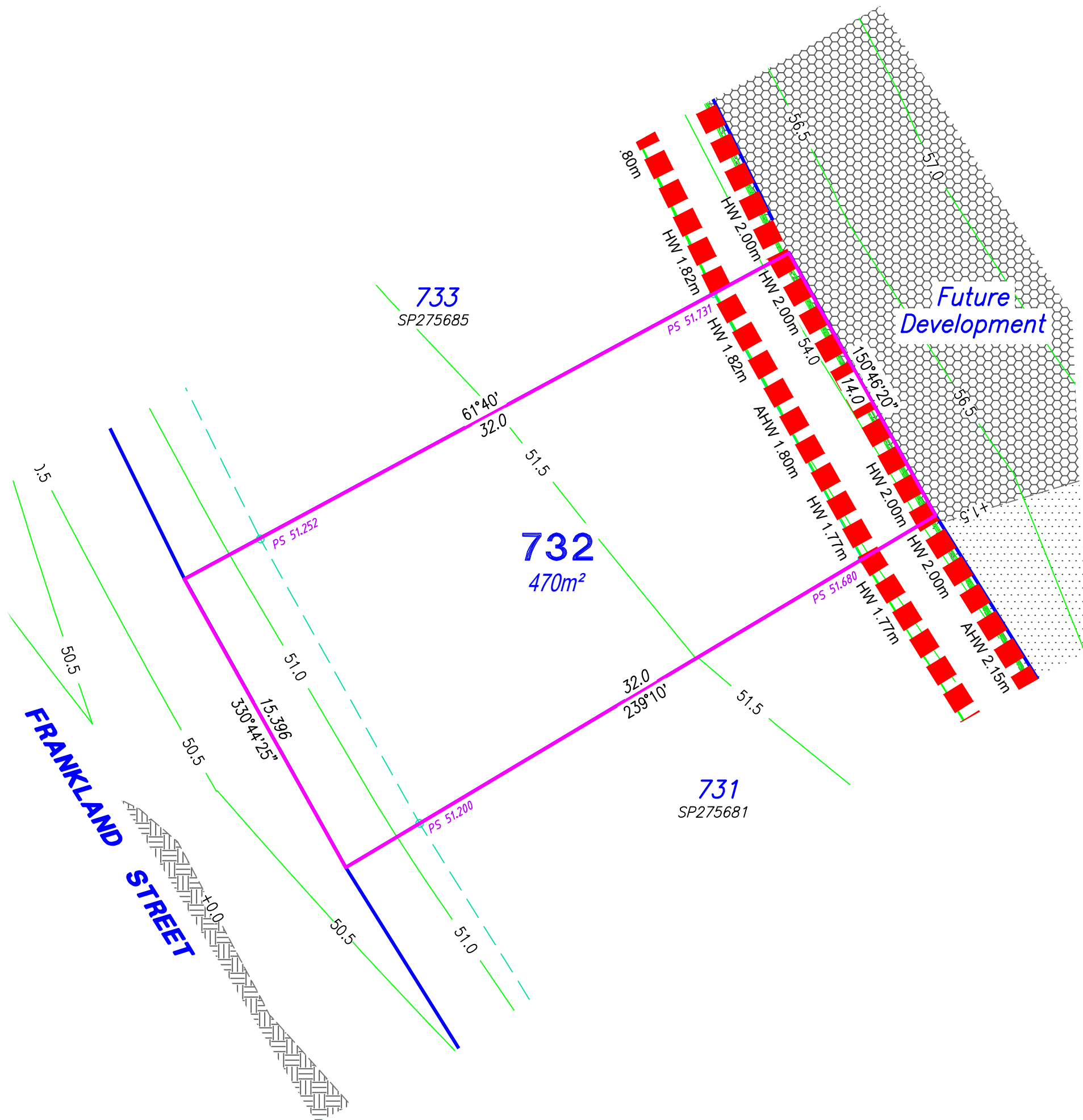

RPS
 RPS Australia East Pty Ltd
 180 Brisbane ROAD
 Ipswich Qld 4305
 t: +61 7 3437 2000
 f: +61 7 3437 2099
 www.rpsgroup.com.au

© COPYRIGHT PROTECTS THIS PLAN
 Unauthorised reproduction or amendment
 not permitted. Please contact the author.

This plan has been prepared by RPS Australia East Pty Ltd
 (Cadastral Surveyor) to satisfy the requirements of the Land Sales
 Act 1984.

CURRENTLY DESCRIBED AS:
 RPD: Lot 732 on SP275685

LOCALITY: South Ripley
 LOCAL AUTHORITY: Ipswich City Council

SCALE 1:200 SHEET SIZE A3

- Notes**
- Proposed contours and retaining wall details are compiled from the engineering design provided by Cardno (Qld) Pty Ltd, received on 20/06/2017.
 - Depth of fill has been calculated from surveys compiled by RPS compared to proposed contours.
 - The location of retaining walls shown are indicative only and may not represent the true width of the wall, refer to engineering drawing.
 - All fill placement has been compacted under Level 1 supervision in accordance with Australian Standard AS3798-2007 'Guidelines on earthworks for commercial and residential developments'.
 - Levels shown are referenced to the Australian Height Datum (AHD) vide PM60301
 - Builders should not build off the design levels shown; a site survey is required.
 - These notes are an integral part of this plan.

Drawn:	EC	Date:	22/06/17
Checked:	JG	Date:	23/06/17
Issue	Description	Date	
DRAFT	Draft plans for review	23/06/17	
ORIG	Issue to client	14/06/17	

SALES PLAN
 For Lot 732
 Providence Ripley - Stage 14

Drawing No.	Plan	Issue
116052Stage14Sales	189/732	

Locality Diagram

Not to Scale

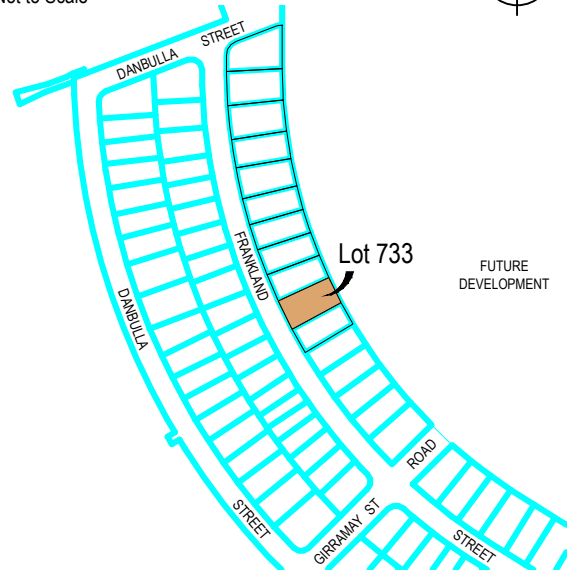

Legend

- Proposed Fence
- Proposed Change of Grade
- Fill Depth Contour
- Proposed Surface Contour
- Retaining Wall
- Proposed Surface Level
- Height of Wall HW 1.6m
- Average Height of Wall AWH 1.4m

- Depth of Fill 0.0m-0.5m
- Depth of Fill 0.5m-1.0m
- Depth of Fill 1.0m-1.5m
- Depth of Fill 1.5m-2.0m
- Depth of Fill 2.0m-2.5m
- Depth of Fill 2.5m-3.0m
- Depth of Fill 3.0m-3.5m
- Depth of Fill 3.5m-4.0m
- Depth of Fill 4.0m-4.5m
- Depth of Fill 4.5m-5.0m
- Depth of Fill 5.0m-5.5m
- Depth of Fill 5.5m-6.0m
- Depth of Fill 6.0m-6.5m

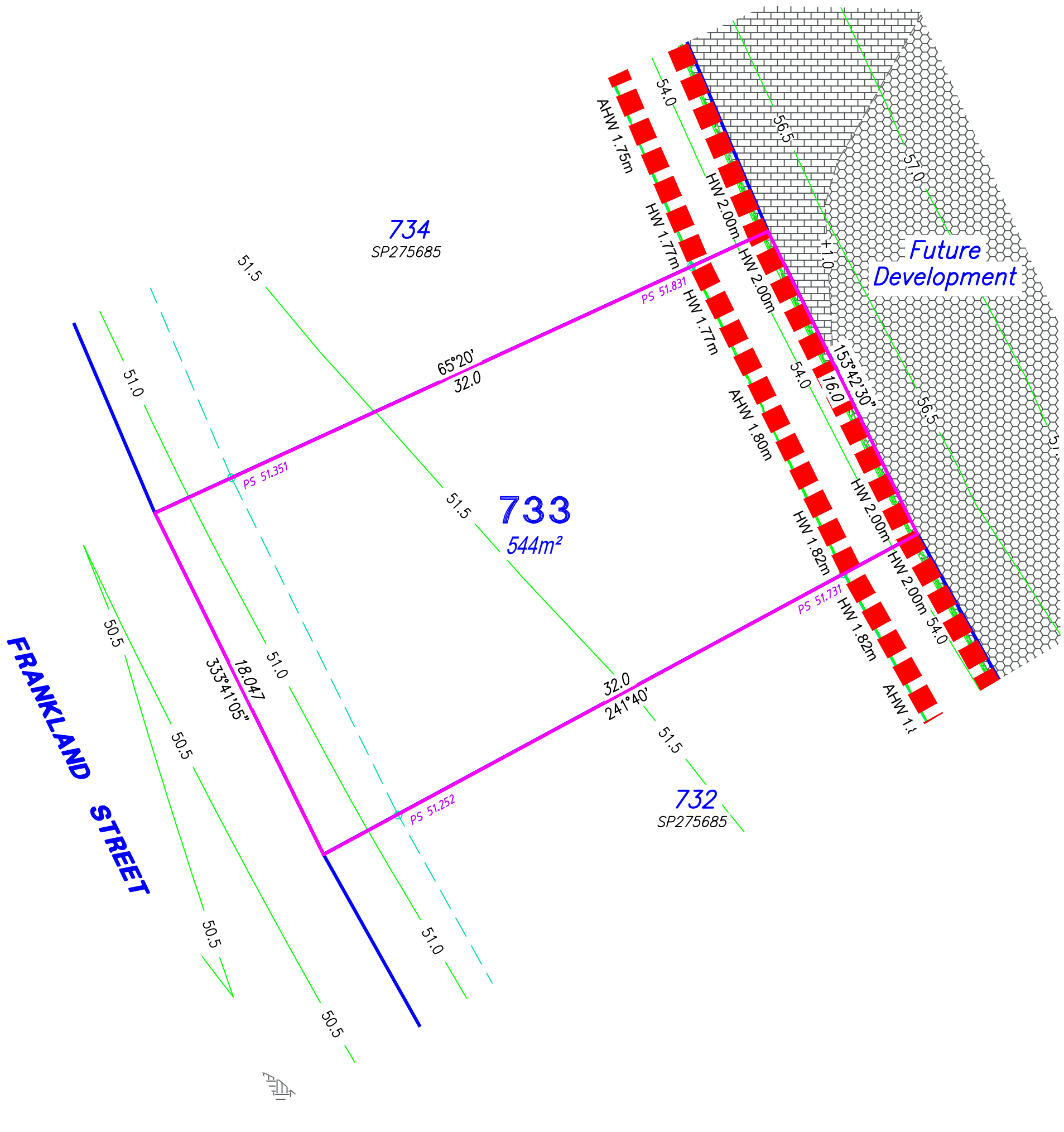

RPS Australia East Pty Ltd
 180 Brisbane ROAD
 Ipswich Qld 4305
 t: +61 7 3437 2000
 f: +61 7 3437 2099
 www.rpsgroup.com.au

© COPYRIGHT PROTECTS THIS PLAN
 Unauthorised reproduction or amendment
 not permitted. Please contact the author.

This plan has been prepared by RPS Australia East Pty Ltd
 (Cadastral Surveyor) to satisfy the requirements of the Land Sales
 Act 1984.

CURRENTLY DESCRIBED AS:
 RPD: Lot 733 on SP275685

LOCALITY: South Ripley
 LOCAL AUTHORITY: Ipswich City Council

SCALE 1:200 SHEET SIZE A3

- Notes**
- Proposed contours and retaining wall details are compiled from the engineering design provided by Cardno (Qld) Pty Ltd, received on 20/06/2017.
 - Depth of fill has been calculated from surveys compiled by RPS compared to proposed contours.
 - The location of retaining walls shown are indicative only and may not represent the true width of the wall, refer to engineering drawing.
 - All fill placement has been compacted under Level 1 supervision in accordance with Australian Standard AS3798-2007 'Guidelines on earthworks for commercial and residential developments'.
 - Levels shown are referenced to the Australian Height Datum (AHD) vide PM60301
 - Builders should not build off the design levels shown; a site survey is required.
 - These notes are an integral part of this plan.

Drawn:	EC	Date:	22/06/17
Checked:	JG	Date:	23/06/17
Issue	Description	Date	
DRAFT	Draft plans for review	23/06/17	
ORIG	Issue to client	14/06/17	

SALES PLAN
 For Lot 733
 Providence Ripley - Stage 14

Drawing No.	Plan	Issue
116052Stage14Sales	189/733	

Locality Diagram

Not to Scale

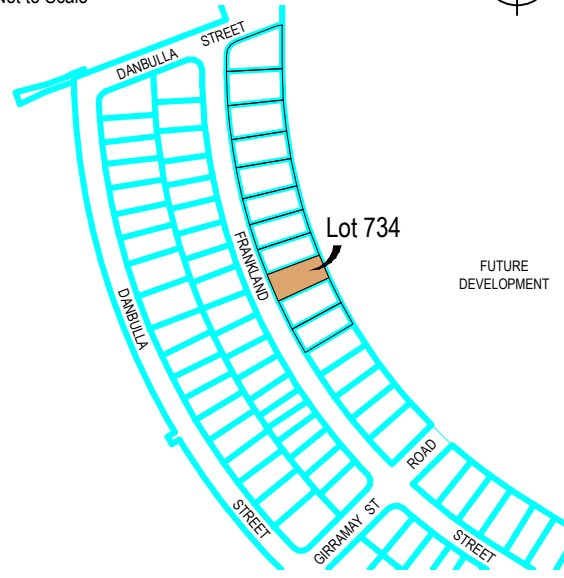

Legend

- Proposed Fence
 - Proposed Change of Grade
 - Fill Depth Contour
 - Proposed Surface Contour
 - Retaining Wall
 - Proposed Surface Level
 - Height of Wall HW 1.6m
 - Average Height of Wall AWH 1.4m
-
- Depth of Fill 0.0m-0.5m
 - Depth of Fill 0.5m-1.0m
 - Depth of Fill 1.0m-1.5m
 - Depth of Fill 1.5m-2.0m
 - Depth of Fill 2.0m-2.5m
 - Depth of Fill 2.5m-3.0m
 - Depth of Fill 3.0m-3.5m
 - Depth of Fill 3.5m-4.0m
 - Depth of Fill 4.0m-4.5m
 - Depth of Fill 4.5m-5.0m
 - Depth of Fill 5.0m-5.5m
 - Depth of Fill 5.5m-6.0m
 - Depth of Fill 6.0m-6.5m

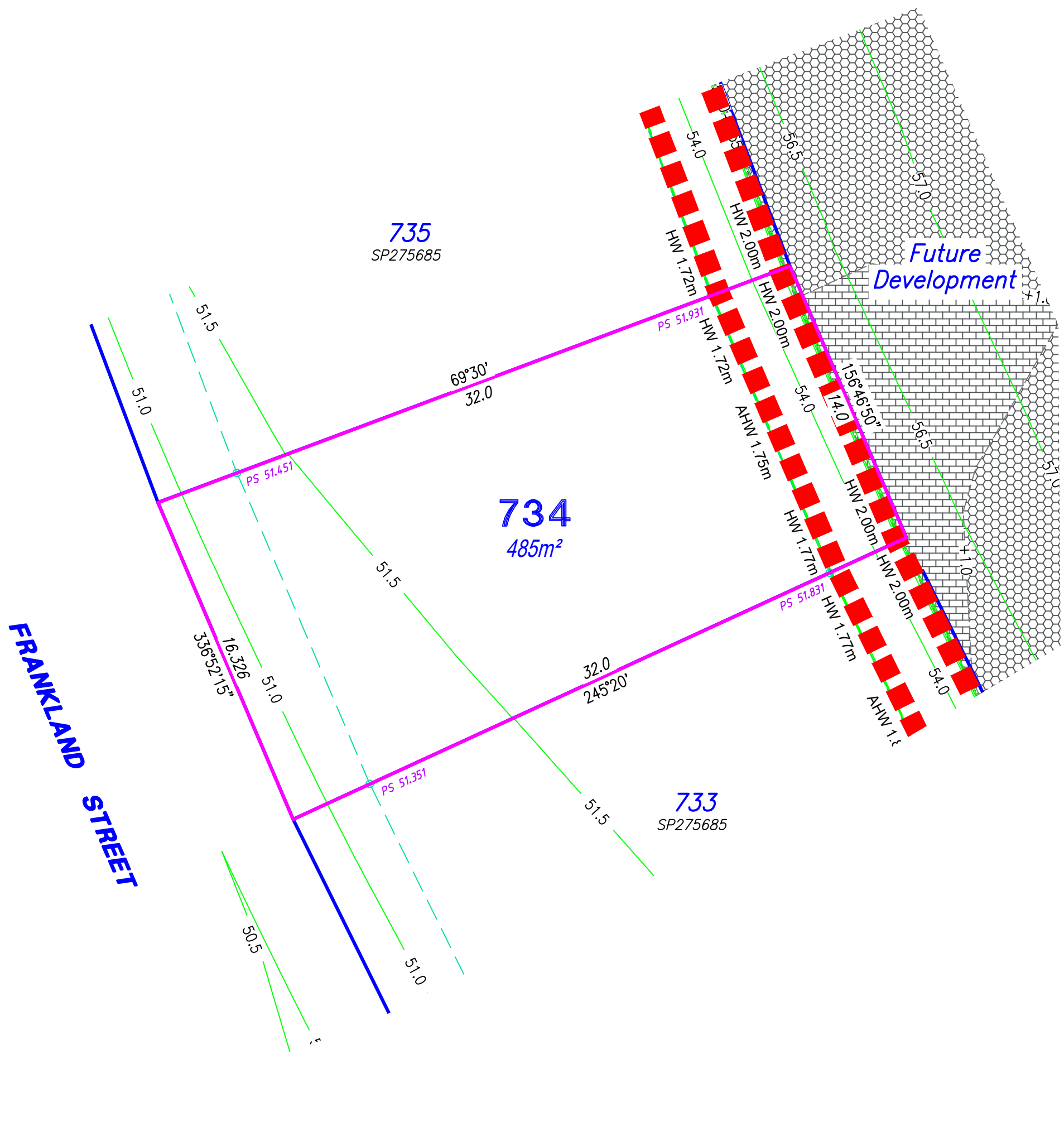

RPS Australia East Pty Ltd
 180 Brisbane ROAD
 Ipswich Qld 4305
 t: +61 7 3437 2000
 f: +61 7 3437 2099
 www.rpsgroup.com.au

© COPYRIGHT PROTECTS THIS PLAN
 Unauthorised reproduction or amendment
 not permitted. Please contact the author.

This plan has been prepared by RPS Australia East Pty Ltd
 (Cadastral Surveyor) to satisfy the requirements of the Land Sales
 Act 1984.

CURRENTLY DESCRIBED AS:
 RPD: Lot 734 on SP275685

LOCALITY: South Ripley
 LOCAL AUTHORITY: Ipswich City Council

SCALE 1:200 SHEET SIZE A3

- Notes**
- Proposed contours and retaining wall details are compiled from the engineering design provided by Cardno (Qld) Pty Ltd, received on 20/06/2017.
 - Depth of fill has been calculated from surveys compiled by RPS compared to proposed contours.
 - The location of retaining walls shown are indicative only and may not represent the true width of the wall, refer to engineering drawing.
 - All fill placement has been compacted under Level 1 supervision in accordance with Australian Standard AS3798-2007 'Guidelines on earthworks for commercial and residential developments'.
 - Levels shown are referenced to the Australian Height Datum (AHD) vide PM60301
 - Builders should not build off the design levels shown; a site survey is required.
 - These notes are an integral part of this plan.

Drawn:	EC	Date:	22/06/17
Checked:	JG	Date:	23/06/17
Issue	Description	Date	
DRAFT	Draft plans for review	23/06/17	
ORIG	Issue to client	14/06/17	

SALES PLAN
 For Lot 734
 Providence Ripley - Stage 14

Drawing No.	Plan	Issue
116052Stage14Sales	189/734	

Locality Diagram

Not to Scale

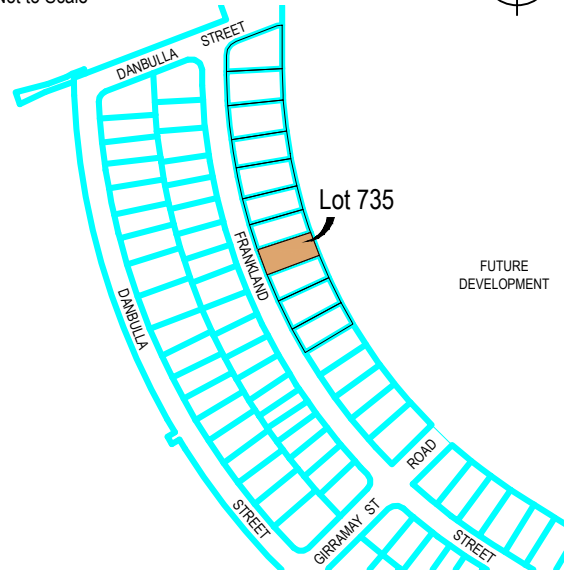

Legend

- Proposed Fence
 - Proposed Change of Grade
 - Fill Depth Contour
 - Proposed Surface Contour
 - Retaining Wall
 - Proposed Surface Level
 - Height of Wall HW 1.6m
 - Average Height of Wall AWH 1.4m
-
- Depth of Fill 0.0m-0.5m
 - Depth of Fill 0.5m-1.0m
 - Depth of Fill 1.0m-1.5m
 - Depth of Fill 1.5m-2.0m
 - Depth of Fill 2.0m-2.5m
 - Depth of Fill 2.5m-3.0m
 - Depth of Fill 3.0m-3.5m
 - Depth of Fill 3.5m-4.0m
 - Depth of Fill 4.0m-4.5m
 - Depth of Fill 4.5m-5.0m
 - Depth of Fill 5.0m-5.5m
 - Depth of Fill 5.5m-6.0m
 - Depth of Fill 6.0m-6.5m

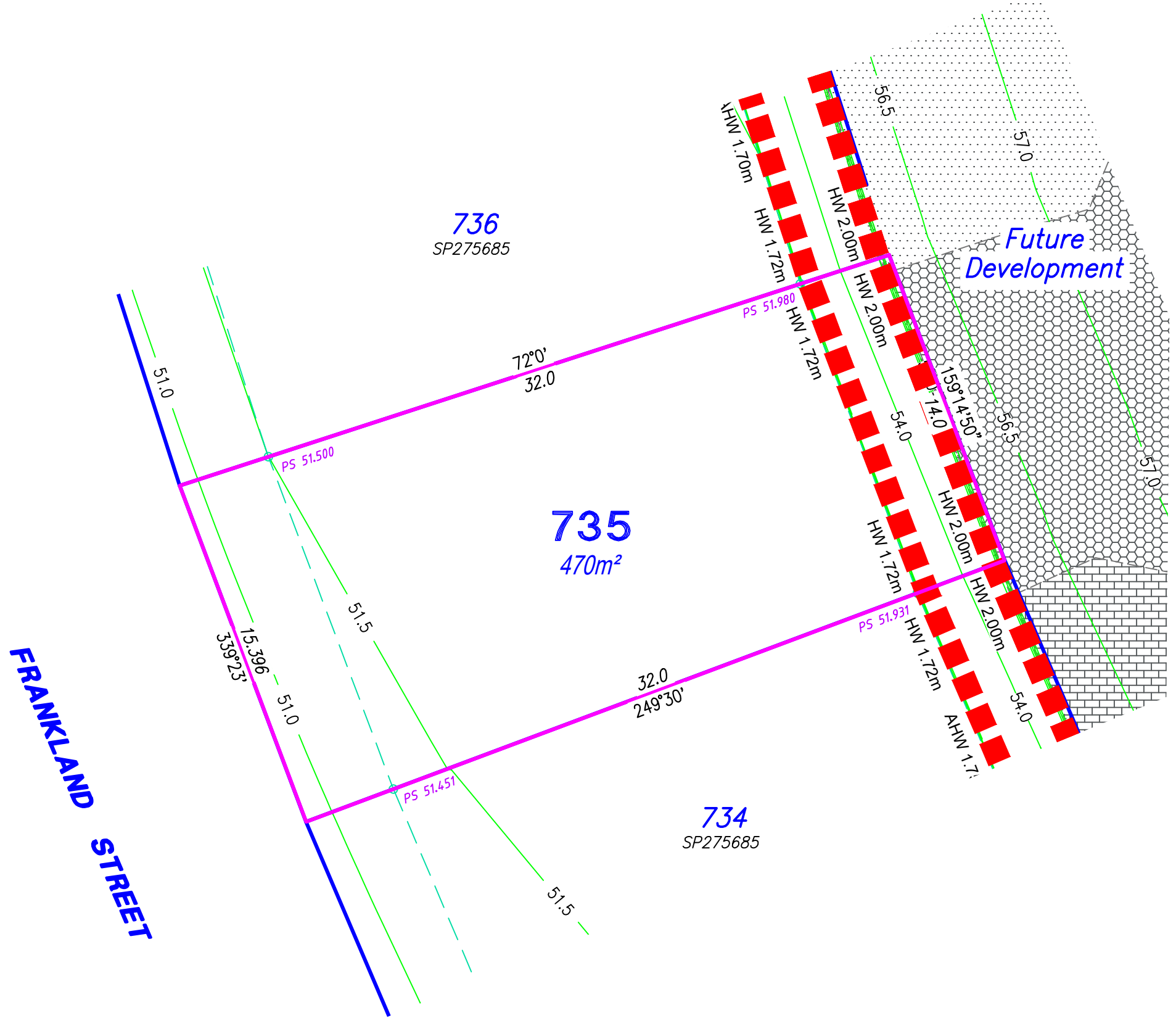

RPS Australia East Pty Ltd
 180 Brisbane ROAD
 Ipswich Qld 4305
 t: +61 7 3437 2000
 f: +61 7 3437 2099
 www.rpsgroup.com.au

© COPYRIGHT PROTECTS THIS PLAN
 Unauthorised reproduction or amendment
 not permitted. Please contact the author.

This plan has been prepared by RPS Australia East Pty Ltd
 (Cadastral Surveyor) to satisfy the requirements of the Land Sales
 Act 1984.

CURRENTLY DESCRIBED AS:
 RP: Lot 735 on SP275685

LOCALITY: South Ripley
 LOCAL AUTHORITY: Ipswich City Council

SCALE 1:200 SHEET SIZE A3

- Notes**
- Proposed contours and retaining wall details are compiled from the engineering design provided by Cardno (Qld) Pty Ltd, received on 20/06/2017.
 - Depth of fill has been calculated from surveys compiled by RPS compared to proposed contours.
 - The location of retaining walls shown are indicative only and may not represent the true width of the wall, refer to engineering drawing.
 - All fill placement has been compacted under Level 1 supervision in accordance with Australian Standard AS3798-2007 'Guidelines on earthworks for commercial and residential developments'.
 - Levels shown are referenced to the Australian Height Datum (AHD) vide PM60301
 - Builders should not build off the design levels shown; a site survey is required.
 - These notes are an integral part of this plan.

Drawn:	EC	Date:	22/06/17
Checked:	JG	Date:	23/06/17
Issue	Description	Date	
DRAFT	Draft plans for review	23/06/17	
ORIG	Issue to client	14/06/17	

SALES PLAN
 For Lot 735
 Providence Ripley - Stage 14

Drawing No. 116052Stage14Sales	Plan 189/735	Issue
-----------------------------------	-----------------	-------

Locality Diagram

Not to Scale

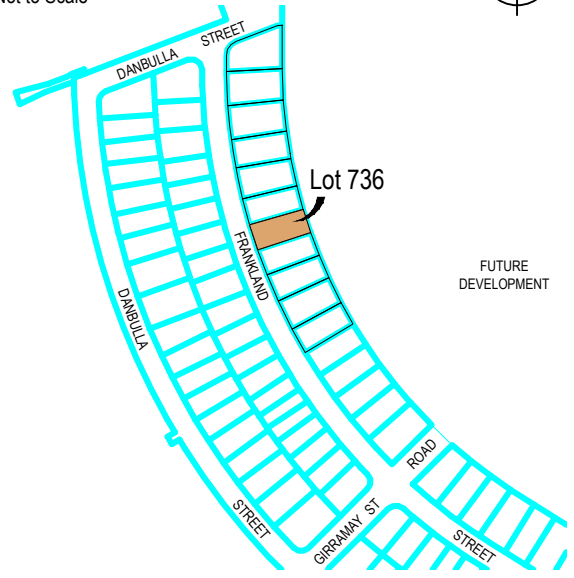

Legend

- Proposed Fence
- Proposed Change of Grade
- Fill Depth Contour
- Proposed Surface Contour
- Retaining Wall
- Proposed Surface Level
- Height of Wall HW 1.6m
- Average Height of Wall AWH 1.4m

- Depth of Fill 0.0m-0.5m
- Depth of Fill 0.5m-1.0m
- Depth of Fill 1.0m-1.5m
- Depth of Fill 1.5m-2.0m
- Depth of Fill 2.0m-2.5m
- Depth of Fill 2.5m-3.0m
- Depth of Fill 3.0m-3.5m
- Depth of Fill 3.5m-4.0m
- Depth of Fill 4.0m-4.5m
- Depth of Fill 4.5m-5.0m
- Depth of Fill 5.0m-5.5m
- Depth of Fill 5.5m-6.0m
- Depth of Fill 6.0m-6.5m

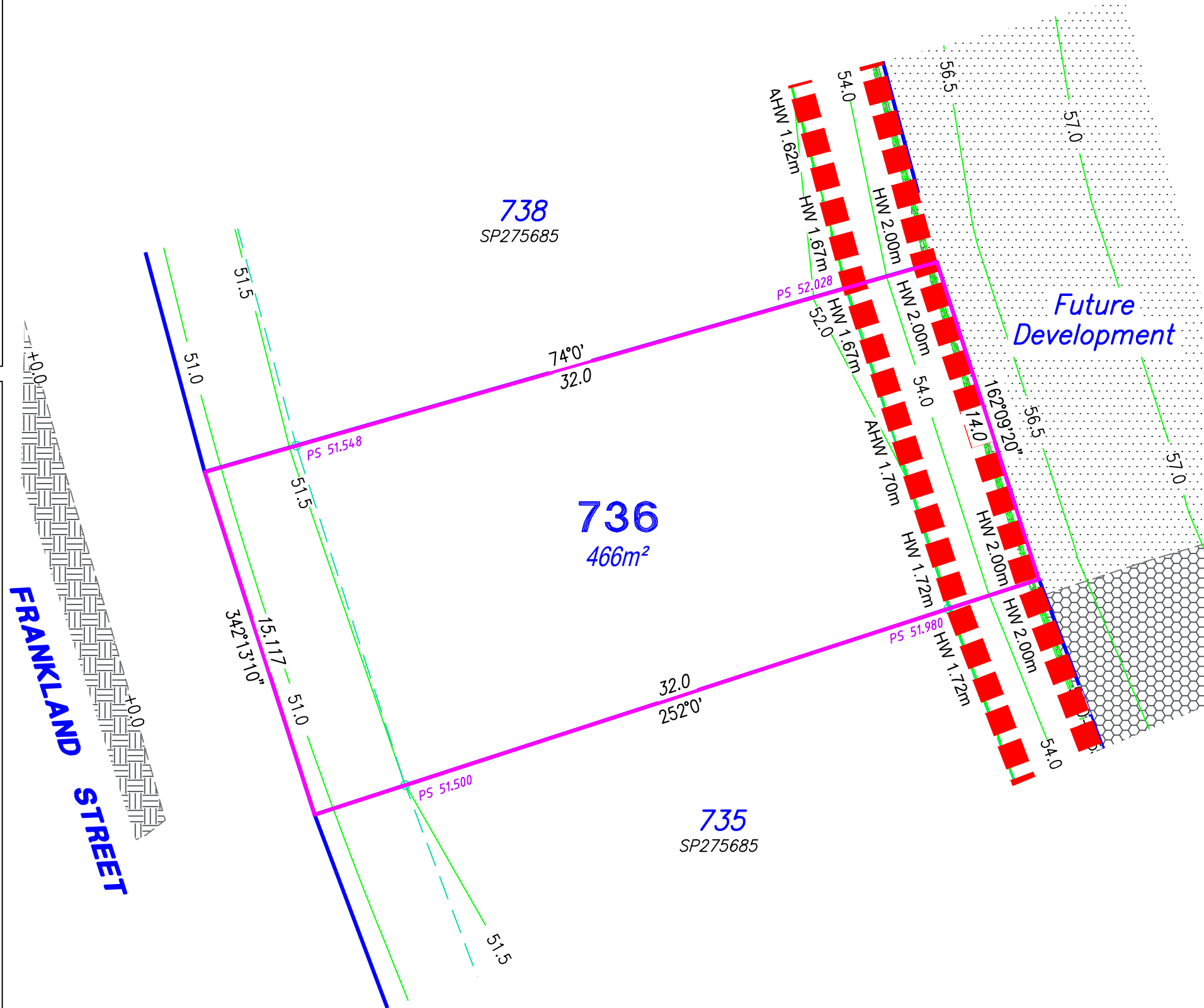

RPS
 RPS Australia East Pty Ltd
 180 Brisbane ROAD
 Ipswich Qld 4305
 t: +61 7 3437 2000
 f: +61 7 3437 2099
 www.rpsgroup.com.au

© COPYRIGHT PROTECTS THIS PLAN
 Unauthorised reproduction or amendment
 not permitted. Please contact the author.

This plan has been prepared by RPS Australia East Pty Ltd
 (Cadastral Surveyor) to satisfy the requirements of the Land Sales
 Act 1984.

CURRENTLY DESCRIBED AS:
 RP: Lot 736 on SP275685

LOCALITY: South Ripley
 LOCAL AUTHORITY: Ipswich City Council

SCALE 1:200 SHEET SIZE A3

- Notes**
- Proposed contours and retaining wall details are compiled from the engineering design provided by Cardno (Qld) Pty Ltd, received on 20/06/2017.
 - Depth of fill has been calculated from surveys compiled by RPS compared to proposed contours.
 - The location of retaining walls shown are indicative only and may not represent the true width of the wall, refer to engineering drawing.
 - All fill placement has been compacted under Level 1 supervision in accordance with Australian Standard AS3798-2007 'Guidelines on earthworks for commercial and residential developments'.
 - Levels shown are referenced to the Australian Height Datum (AHD) vide PM60301
 - Builders should not build off the design levels shown; a site survey is required.
 - These notes are an integral part of this plan.

Drawn:	EC	Date:	22/06/17
Checked:	JG	Date:	23/06/17
Issue	Description	Date	
DRAFT	Draft plans for review	23/06/17	
ORIG	Issue to client	14/06/17	

SALES PLAN
 For Lot 736
 Providence Ripley - Stage 14

Drawing No.	Plan	Issue
116052Stage14Sales	189/736	

Locality Diagram

Not to Scale

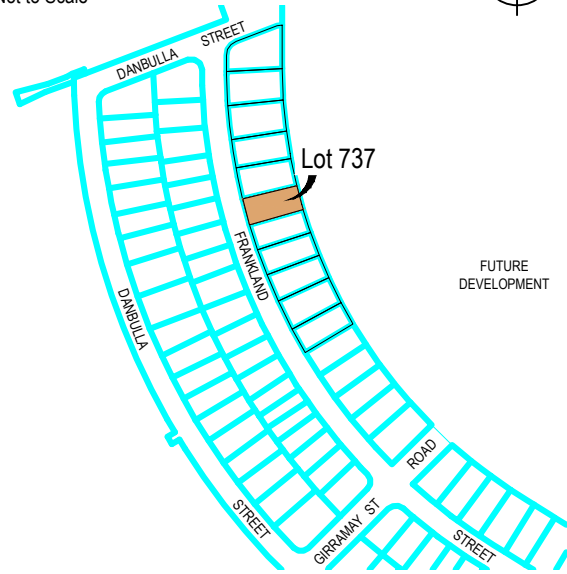

Legend

- Proposed Fence
- Proposed Change of Grade
- Fill Depth Contour
- Proposed Surface Contour
- Retaining Wall
- Proposed Surface Level
- Height of Wall
- Average Height of Wall

- Depth of Fill 0.0m-0.5m
- Depth of Fill 0.5m-1.0m
- Depth of Fill 1.0m-1.5m
- Depth of Fill 1.5m-2.0m
- Depth of Fill 2.0m-2.5m
- Depth of Fill 2.5m-3.0m
- Depth of Fill 3.0m-3.5m
- Depth of Fill 3.5m-4.0m
- Depth of Fill 4.0m-4.5m
- Depth of Fill 4.5m-5.0m
- Depth of Fill 5.0m-5.5m
- Depth of Fill 5.5m-6.0m
- Depth of Fill 6.0m-6.5m

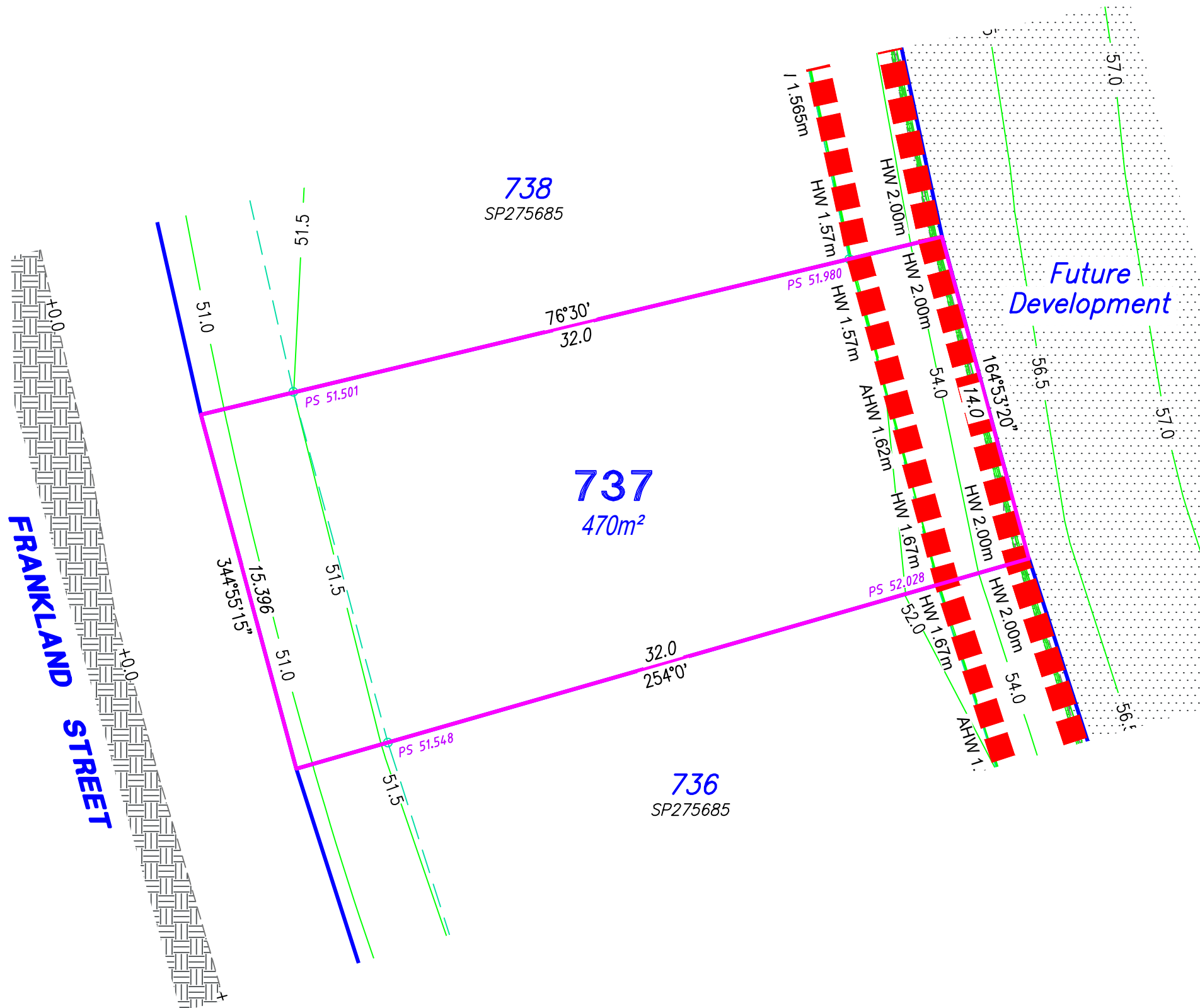

RPS
 RPS Australia East Pty Ltd
 180 Brisbane ROAD
 Ipswich Qld 4305
 t: +61 7 3437 2000
 f: +61 7 3437 2099
 www.rpsgroup.com.au

© COPYRIGHT PROTECTS THIS PLAN
 Unauthorised reproduction or amendment
 not permitted. Please contact the author.

This plan has been prepared by RPS Australia East Pty Ltd
 (Cadastral Surveyor) to satisfy the requirements of the Land Sales
 Act 1984.

CURRENTLY DESCRIBED AS:
 RP: Lot 737 on SP275685

LOCALITY: South Ripley
 LOCAL AUTHORITY: Ipswich City Council

SCALE: 1:200 SHEET SIZE: A3

- Notes**
- Proposed contours and retaining wall details are compiled from the engineering design provided by Cardno (Qld) Pty Ltd, received on 20/06/2017.
 - Depth of fill has been calculated from surveys compiled by RPS compared to proposed contours.
 - The location of retaining walls shown are indicative only and may not represent the true width of the wall, refer to engineering drawing.
 - All fill placement has been compacted under Level 1 supervision in accordance with Australian Standard AS3798-2007 'Guidelines on earthworks for commercial and residential developments'.
 - Levels shown are referenced to the Australian Height Datum (AHD) vide PM60301
 - Builders should not build off the design levels shown; a site survey is required.
 - These notes are an integral part of this plan.

Drawn:	EC	Date:	22/06/17
Checked:	JG	Date:	23/06/17
Issue	Description	Date	
DRAFT	Draft plans for review	23/06/17	
ORIG	Issue to client	14/06/17	

SALES PLAN
 For Lot 737
 Providence Ripley - Stage 14

Drawing No.	Plan	Issue
116052Stage14Sales	189/737	

Locality Diagram

Not to Scale

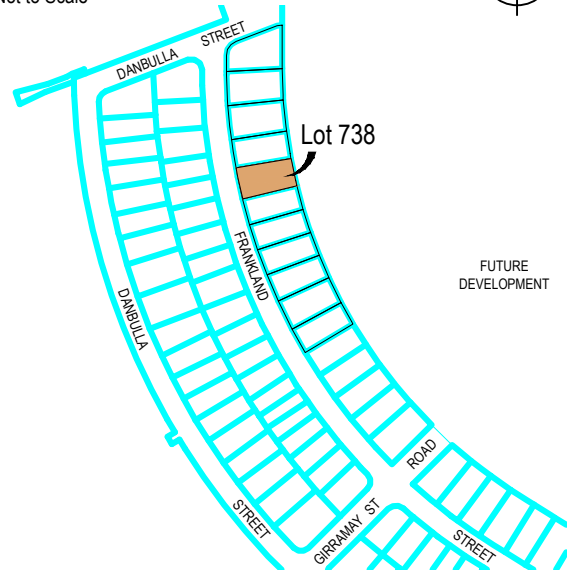

FUTURE DEVELOPMENT

Legend

- Proposed Fence
- Proposed Change of Grade
- Fill Depth Contour
- Proposed Surface Contour
- Retaining Wall
- Proposed Surface Level
- Height of Wall HW 1.6m
- Average Height of Wall AWH 1.4m

- Depth of Fill 0.0m-0.5m
- Depth of Fill 0.5m-1.0m
- Depth of Fill 1.0m-1.5m
- Depth of Fill 1.5m-2.0m
- Depth of Fill 2.0m-2.5m
- Depth of Fill 2.5m-3.0m
- Depth of Fill 3.0m-3.5m
- Depth of Fill 3.5m-4.0m
- Depth of Fill 4.0m-4.5m
- Depth of Fill 4.5m-5.0m
- Depth of Fill 5.0m-5.5m
- Depth of Fill 5.5m-6.0m
- Depth of Fill 6.0m-6.5m

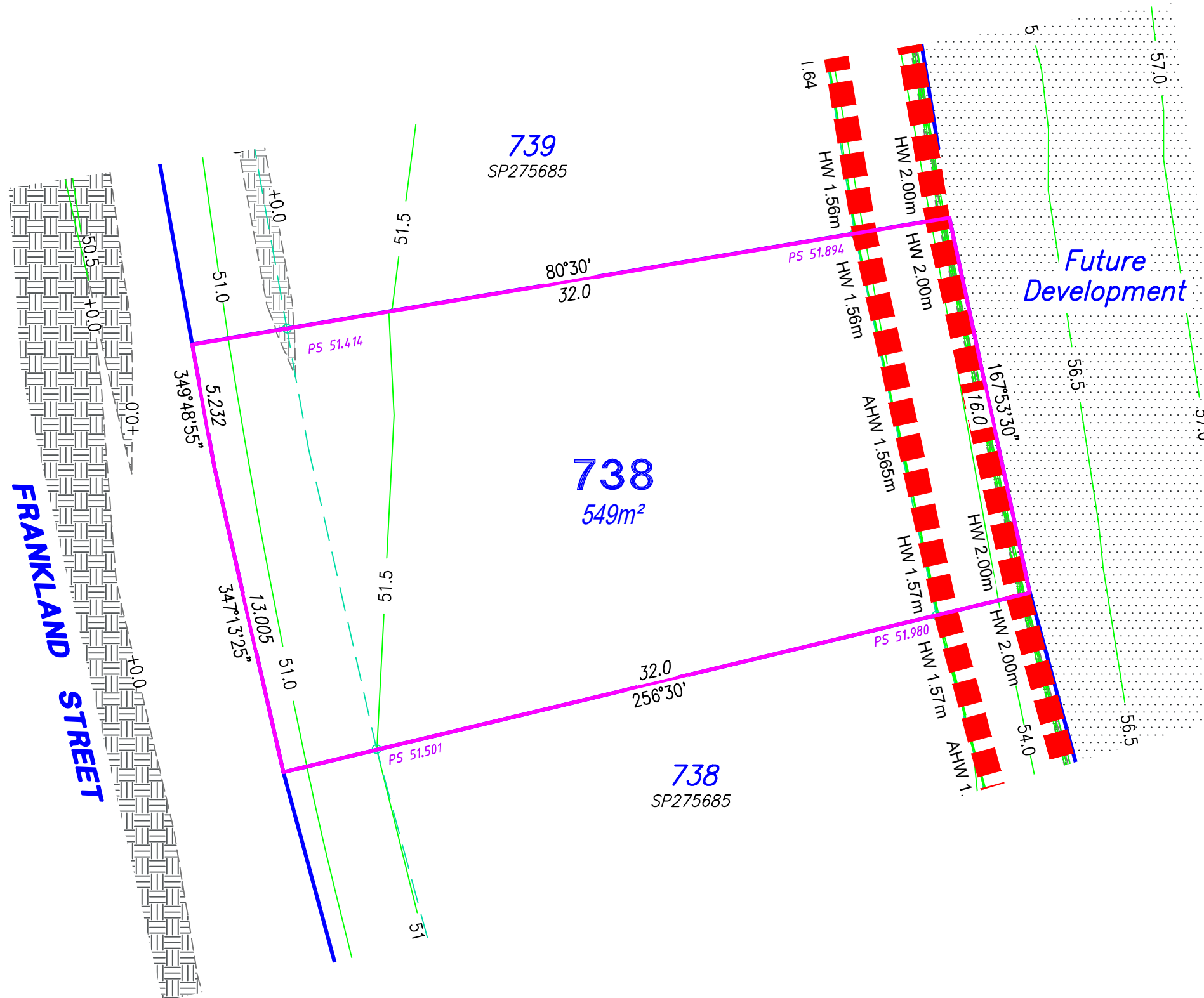

RPS
 RPS Australia East Pty Ltd
 180 Brisbane ROAD
 Ipswich Qld 4305
 t: +61 7 3437 2000
 f: +61 7 3437 2099
 www.rpsgroup.com.au

© COPYRIGHT PROTECTS THIS PLAN
 Unauthorised reproduction or amendment
 not permitted. Please contact the author.

This plan has been prepared by RPS Australia East Pty Ltd
 (Cadastral Surveyor) to satisfy the requirements of the Land Sales
 Act 1984.

CURRENTLY DESCRIBED AS:
 RP: Lot 738 on SP275685

LOCALITY: South Ripley
 LOCAL AUTHORITY: Ipswich City Council



- Notes**
- Proposed contours and retaining wall details are compiled from the engineering design provided by Cardno (Qld) Pty Ltd, received on 20/06/2017.
 - Depth of fill has been calculated from surveys compiled by RPS compared to proposed contours.
 - The location of retaining walls shown are indicative only and may not represent the true width of the wall, refer to engineering drawing.
 - All fill placement has been compacted under Level 1 supervision in accordance with Australian Standard AS3798-2007 'Guidelines on earthworks for commercial and residential developments'.
 - Levels shown are referenced to the Australian Height Datum (AHD) vide PM60301
 - Builders should not build off the design levels shown; a site survey is required.
 - These notes are an integral part of this plan.

Drawn:	EC	Date:	22/06/17
Checked:	JG	Date:	23/06/17
Issue	Description	Date	
DRAFT	Draft plans for review	23/06/17	
ORIG	Issue to client	14/06/17	

SALES PLAN
 For Lot 738
 Providence Ripley - Stage 14

Drawing No.	Plan	Issue
116052Stage14Sales	189/738	

Locality Diagram

Not to Scale

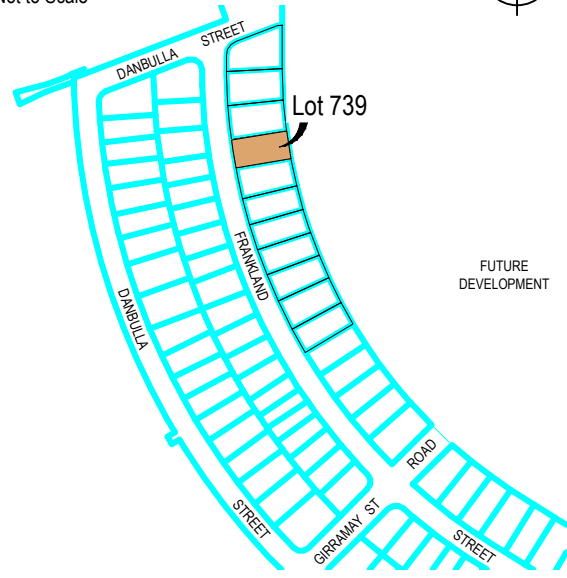

FUTURE DEVELOPMENT

Legend

- Proposed Fence
 - Proposed Change of Grade
 - Fill Depth Contour
 - Proposed Surface Contour
 - Retaining Wall
 - Proposed Surface Level
 - Height of Wall
 - Average Height of Wall
-
- Depth of Fill 0.0m-0.5m
 - Depth of Fill 0.5m-1.0m
 - Depth of Fill 1.0m-1.5m
 - Depth of Fill 1.5m-2.0m
 - Depth of Fill 2.0m-2.5m
 - Depth of Fill 2.5m-3.0m
 - Depth of Fill 3.0m-3.5m
 - Depth of Fill 3.5m-4.0m
 - Depth of Fill 4.0m-4.5m
 - Depth of Fill 4.5m-5.0m
 - Depth of Fill 5.0m-5.5m
 - Depth of Fill 5.5m-6.0m
 - Depth of Fill 6.0m-6.5m

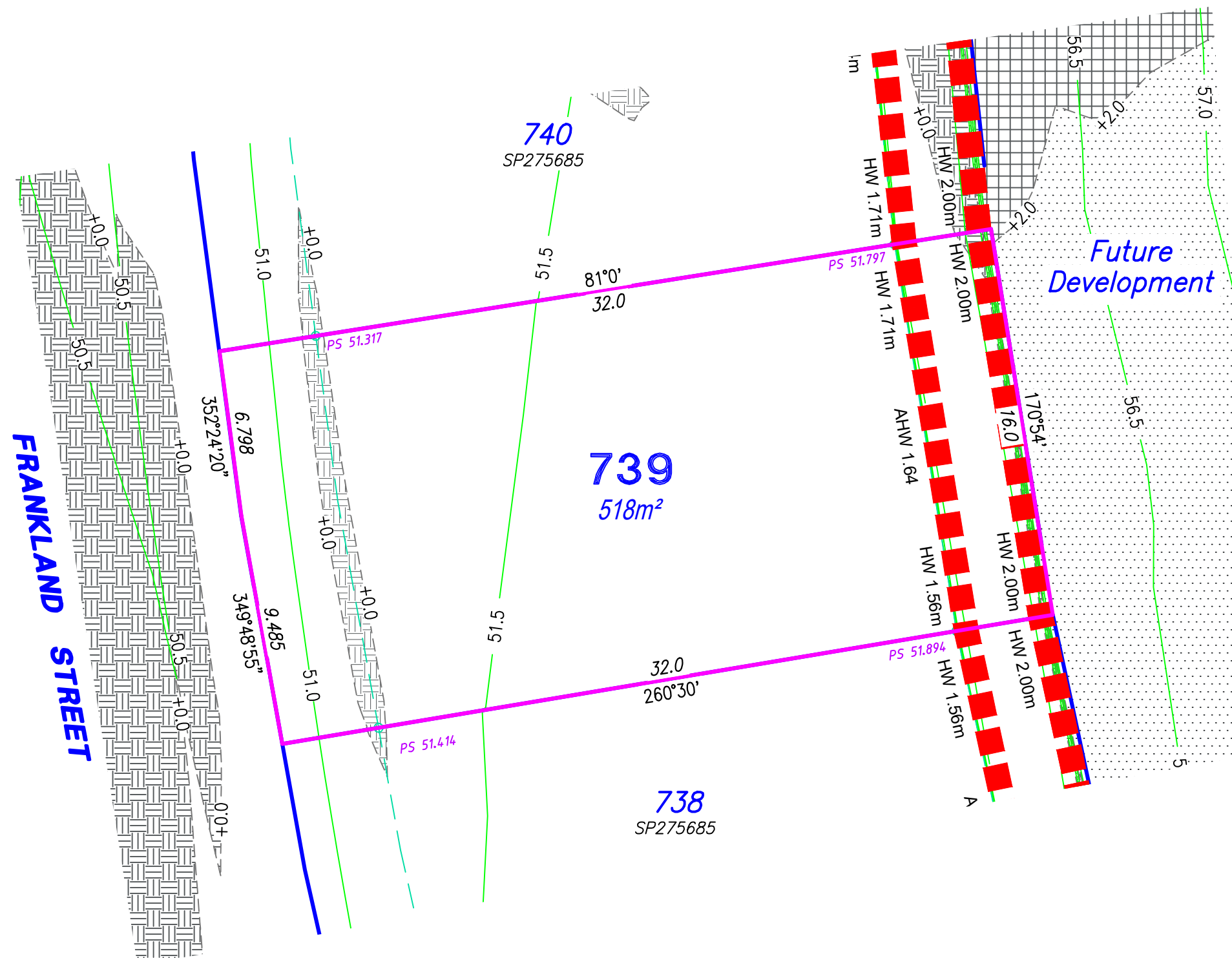

RPS Australia East Pty Ltd
 180 Brisbane ROAD
 Ipswich Qld 4305
 t: +61 7 3437 2000
 f: +61 7 3437 2099
 www.rpsgroup.com.au

© COPYRIGHT PROTECTS THIS PLAN
 Unauthorised reproduction or amendment
 not permitted. Please contact the author.

This plan has been prepared by RPS Australia East Pty Ltd
 (Cadastral Surveyor) to satisfy the requirements of the Land Sales
 Act 1984.

CURRENTLY DESCRIBED AS:
 RPD: Lot 739 on SP275685

LOCALITY: South Ripley
 LOCAL AUTHORITY: Ipswich City Council



- Notes**
- Proposed contours and retaining wall details are compiled from the engineering design provided by Cardno (Qld) Pty Ltd, received on 20/06/2017.
 - Depth of fill has been calculated from surveys compiled by RPS compared to proposed contours.
 - The location of retaining walls shown are indicative only and may not represent the true width of the wall, refer to engineering drawing.
 - All fill placement has been compacted under Level 1 supervision in accordance with Australian Standard AS3798-2007 'Guidelines on earthworks for commercial and residential developments'.
 - Levels shown are referenced to the Australian Height Datum (AHD) vide PM60301
 - Builders should not build off the design levels shown; a site survey is required.
 - These notes are an integral part of this plan.

Drawn:	EC	Date:	22/06/17
Checked:	JG	Date:	23/06/17
Issue	Description	Date	
DRAFT	Draft plans for review	23/06/17	
ORIG	Issue to client	14/06/17	

SALES PLAN
 For Lot 739
 Providence Ripley - Stage 14

Drawing No.	Plan	Issue
116052Stage14Sales	189/739	

Locality Diagram

Not to Scale

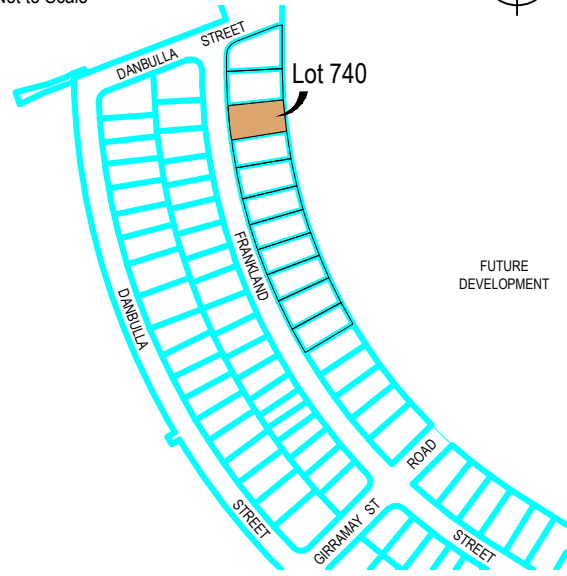

FUTURE DEVELOPMENT

Legend

- Proposed Fence
- Proposed Change of Grade
- Fill Depth Contour
- Proposed Surface Contour
- Retaining Wall
- Proposed Surface Level
- Height of Wall
- Average Height of Wall

- Depth of Fill 0.0m-0.5m
- Depth of Fill 0.5m-1.0m
- Depth of Fill 1.0m-1.5m
- Depth of Fill 1.5m-2.0m
- Depth of Fill 2.0m-2.5m
- Depth of Fill 2.5m-3.0m
- Depth of Fill 3.0m-3.5m
- Depth of Fill 3.5m-4.0m
- Depth of Fill 4.0m-4.5m
- Depth of Fill 4.5m-5.0m
- Depth of Fill 5.0m-5.5m
- Depth of Fill 5.5m-6.0m
- Depth of Fill 6.0m-6.5m

FRANKLAND STREET

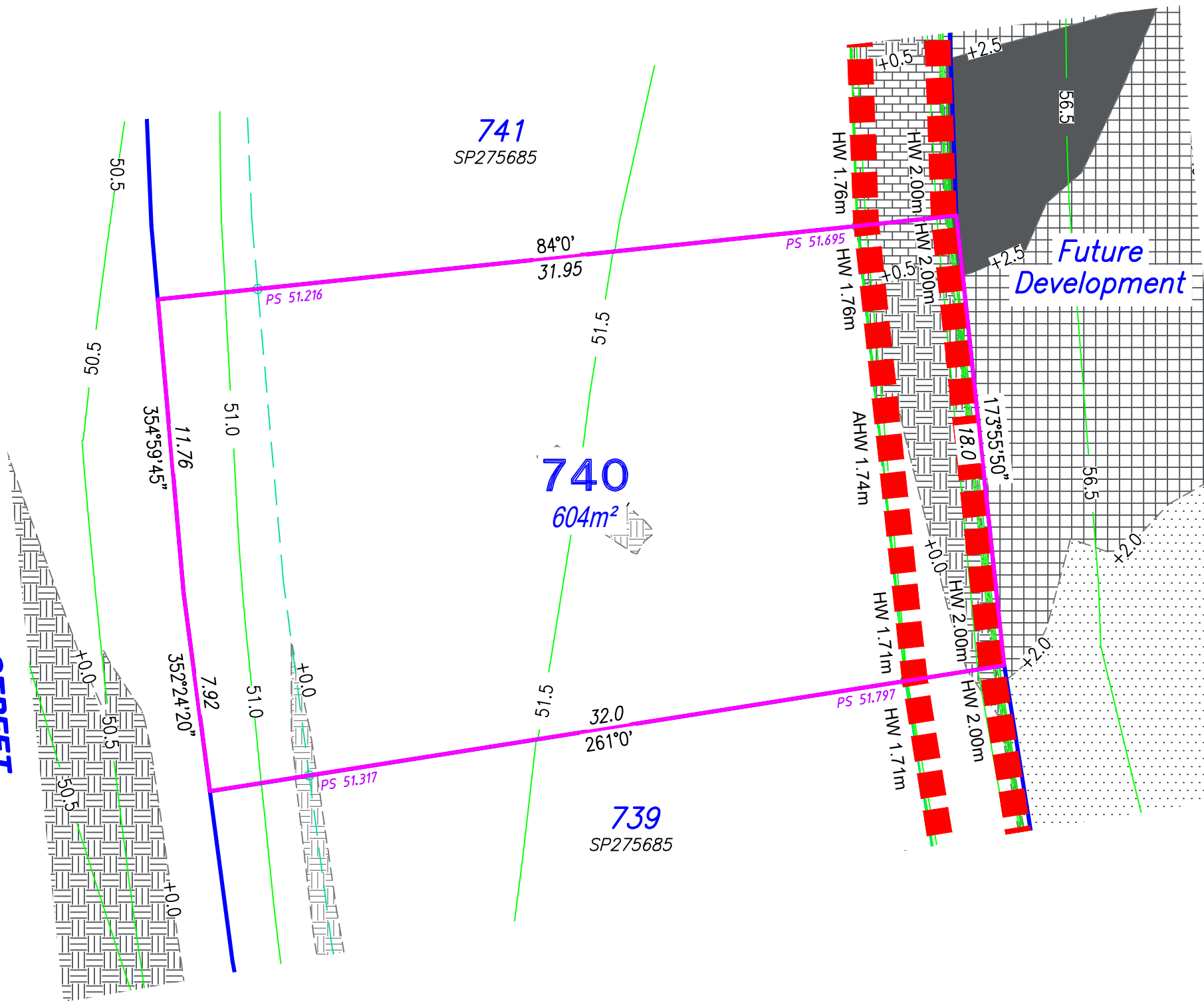

RPS
 RPS Australia East Pty Ltd
 180 Brisbane ROAD
 Ipswich Qld 4305
 t: +61 7 3437 2000
 f: +61 7 3437 2099
 www.rpsgroup.com.au

© COPYRIGHT PROTECTS THIS PLAN
 Unauthorised reproduction or amendment
 not permitted. Please contact the author.

This plan has been prepared by RPS Australia East Pty Ltd
 (Cadastral Surveyor) to satisfy the requirements of the Land Sales
 Act 1984.

CURRENTLY DESCRIBED AS:
 RPD: Lot 740 on SP275685

LOCALITY: South Ripley
 LOCAL AUTHORITY: Ipswich City Council

SCALE 1:200 SHEET SIZE A3

- Notes
- Proposed contours and retaining wall details are compiled from the engineering design provided by Cardno (Qld) Pty Ltd, received on 20/06/2017.
 - Depth of fill has been calculated from surveys compiled by RPS compared to proposed contours.
 - The location of retaining walls shown are indicative only and may not represent the true width of the wall, refer to engineering drawing.
 - All fill placement has been compacted under Level 1 supervision in accordance with Australian Standard AS3798-2007 'Guidelines on earthworks for commercial and residential developments'.
 - Levels shown are referenced to the Australian Height Datum (AHD) vide PM60301
 - Builders should not build off the design levels shown; a site survey is required.
 - These notes are an integral part of this plan.

Drawn:	EC	Date:	22/06/17
Checked:	JG	Date:	23/06/17
Issue	Description	Date	
DRAFT	Draft plans for review	23/06/17	
ORIG	Issue to client	14/06/17	

SALES PLAN
 For Lot 740
 Providence Ripley - Stage 14

Drawing No.	Plan	Issue
116052Stage14Sales	189/740	

Locality Diagram

Not to Scale

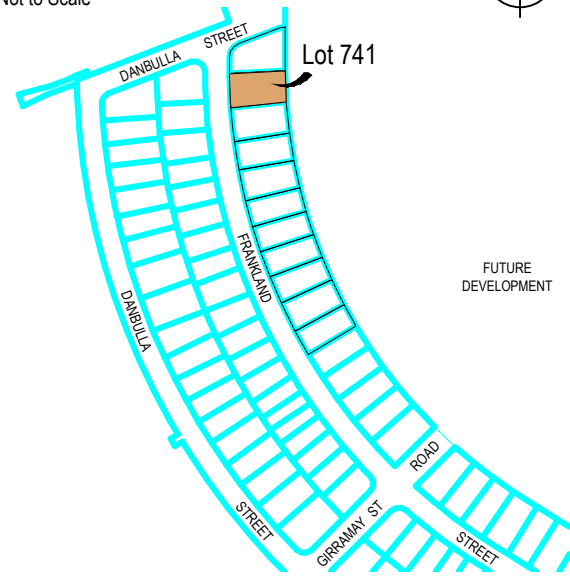

Legend

- Proposed Fence
- Proposed Change of Grade
- Fill Depth Contour
- Proposed Surface Contour
- Retaining Wall
- Proposed Surface Level
- Height of Wall HW 1.6m
- Average Height of Wall AWH 1.4m

- Depth of Fill 0.0m-0.5m
- Depth of Fill 0.5m-1.0m
- Depth of Fill 1.0m-1.5m
- Depth of Fill 1.5m-2.0m
- Depth of Fill 2.0m-2.5m
- Depth of Fill 2.5m-3.0m
- Depth of Fill 3.0m-3.5m
- Depth of Fill 3.5m-4.0m
- Depth of Fill 4.0m-4.5m
- Depth of Fill 4.5m-5.0m
- Depth of Fill 5.0m-5.5m
- Depth of Fill 5.5m-6.0m
- Depth of Fill 6.0m-6.5m

FRANKLAND STREET

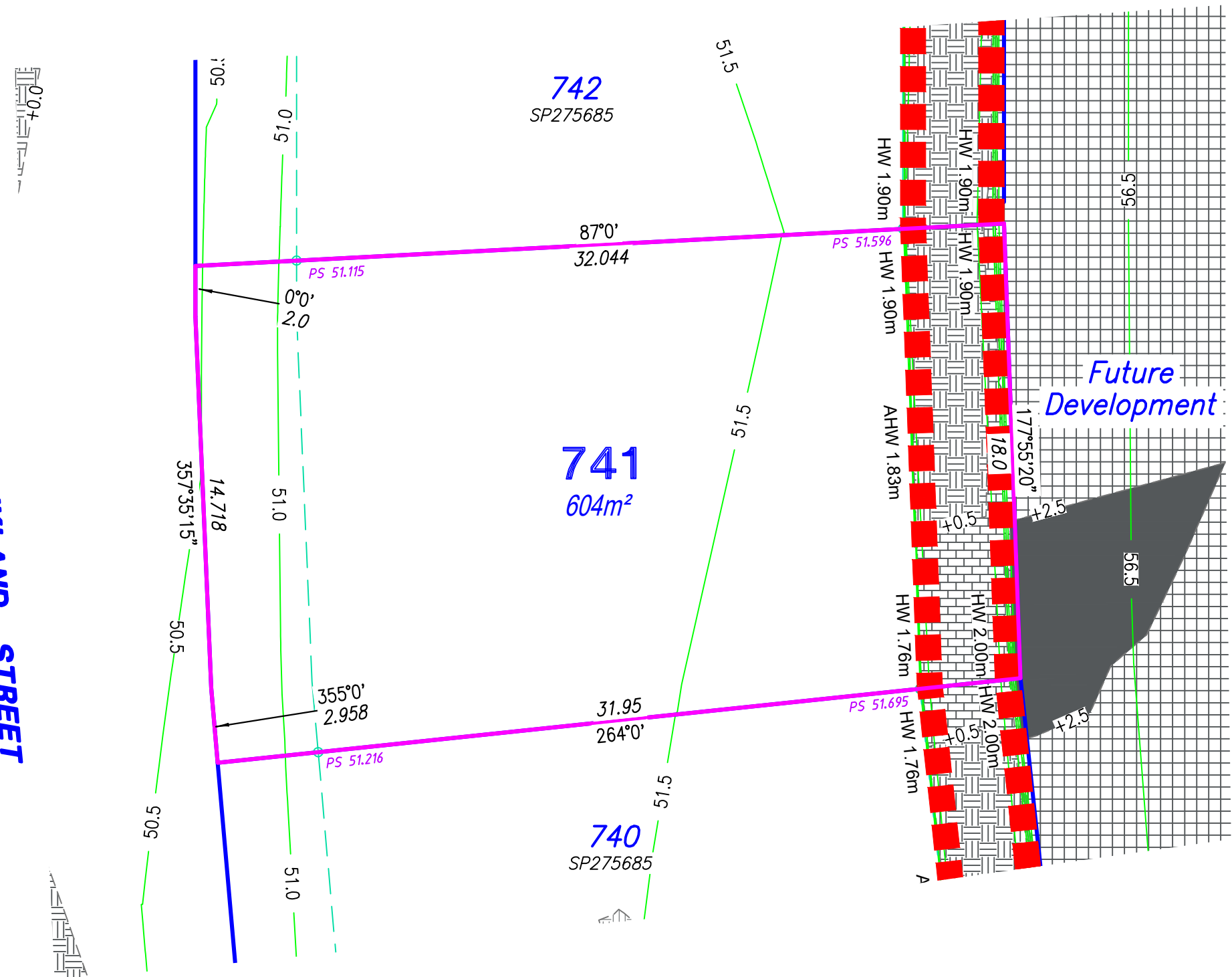

RPS
 RPS Australia East Pty Ltd
 180 Brisbane ROAD
 Ipswich Qld 4305
 t: +61 7 3437 2000
 f: +61 7 3437 2099
 www.rpsgroup.com.au

© COPYRIGHT PROTECTS THIS PLAN
 Unauthorised reproduction or amendment
 not permitted. Please contact the author.

This plan has been prepared by RPS Australia East Pty Ltd
 (Cadastral Surveyor) to satisfy the requirements of the Land Sales
 Act 1984.

CURRENTLY DESCRIBED AS:
 RP: Lot 741 on SP275685

LOCALITY: South Ripley
 LOCAL AUTHORITY: Ipswich City Council

SCALE 1:200 SHEET SIZE A3

- Notes**
- Proposed contours and retaining wall details are compiled from the engineering design provided by Cardno (Qld) Pty Ltd, received on 20/06/2017.
 - Depth of fill has been calculated from surveys compiled by RPS compared to proposed contours.
 - The location of retaining walls shown are indicative only and may not represent the true width of the wall, refer to engineering drawing.
 - All fill placement has been compacted under Level 1 supervision in accordance with Australian Standard AS3798-2007 'Guidelines on earthworks for commercial and residential developments'.
 - Levels shown are referenced to the Australian Height Datum (AHD) vide PM60301
 - Builders should not build off the design levels shown; a site survey is required.
 - These notes are an integral part of this plan.

Drawn:	EC	Date:	22/06/17
Checked:	JG	Date:	23/06/17
Issue	Description	Date	
DRAFT	Draft plans for review	23/06/17	
ORIG	Issue to client	14/06/17	

SALES PLAN
 For Lot 741
 Providence Ripley - Stage 14

Drawing No.	Plan	Issue
116052Stage14Sales	189/741	

Locality Diagram

Not to Scale

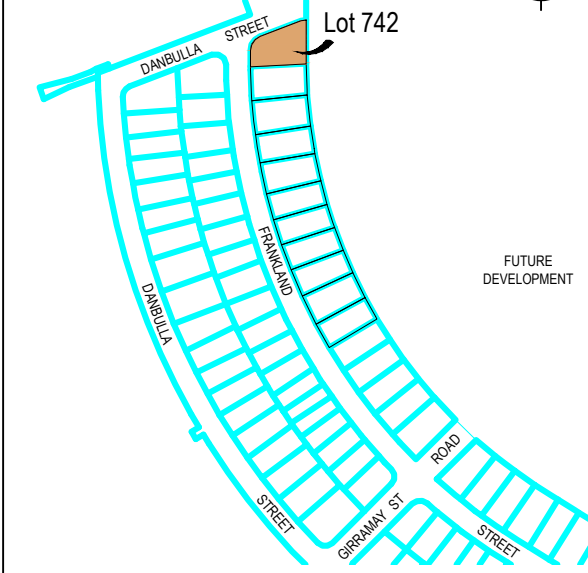

Legend

- Proposed Fence
 - Proposed Change of Grade
 - Fill Depth Contour
 - Proposed Surface Contour
 - Retaining Wall
 - Proposed Surface Level
 - Height of Wall
 - Average Height of Wall
-
- Depth of Fill 0.0m-0.5m
 - Depth of Fill 0.5m-1.0m
 - Depth of Fill 1.0m-1.5m
 - Depth of Fill 1.5m-2.0m
 - Depth of Fill 2.0m-2.5m
 - Depth of Fill 2.5m-3.0m
 - Depth of Fill 3.0m-3.5m
 - Depth of Fill 3.5m-4.0m
 - Depth of Fill 4.0m-4.5m
 - Depth of Fill 4.5m-5.0m
 - Depth of Fill 5.0m-5.5m
 - Depth of Fill 5.5m-6.0m
 - Depth of Fill 6.0m-6.5m

FRANKLAND STREET

DANBULLA STREET

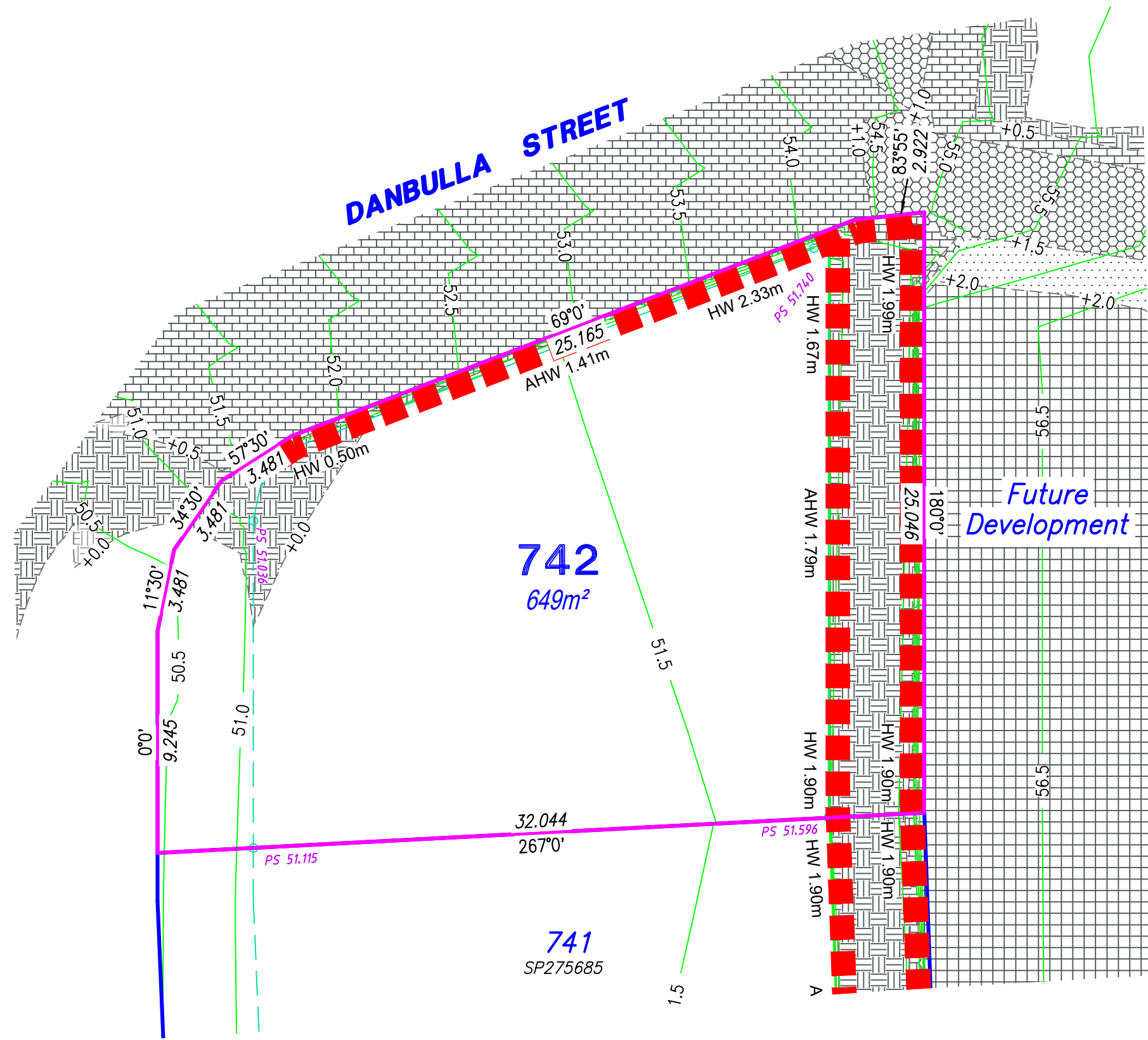

RPS Australia East Pty Ltd
 180 Brisbane ROAD
 Ipswich Qld 4305
 t: +61 7 3437 2000
 f: +61 7 3437 2099
 www.rpsgroup.com.au

© COPYRIGHT PROTECTS THIS PLAN
 Unauthorised reproduction or amendment
 not permitted. Please contact the author.

This plan has been prepared by RPS Australia East Pty Ltd
 (Cadastral Surveyor) to satisfy the requirements of the Land Sales
 Act 1984.

CURRENTLY DESCRIBED AS:
 RP: Lot 742 on SP275685

LOCALITY: South Ripley
 LOCAL AUTHORITY: Ipswich City Council

SCALE: 1:200 SHEET SIZE: A3

- Notes**
- Proposed contours and retaining wall details are compiled from the engineering design provided by Cardno (Qld) Pty Ltd, received on 20/06/2017.
 - Depth of fill has been calculated from surveys compiled by RPS compared to proposed contours.
 - The location of retaining walls shown are indicative only and may not represent the true width of the wall, refer to engineering drawing.
 - All fill placement has been compacted under Level 1 supervision in accordance with Australian Standard AS3798-2007 'Guidelines on earthworks for commercial and residential developments'.
 - Levels shown are referenced to the Australian Height Datum (AHD) vide PM60301
 - Builders should not build off the design levels shown; a site survey is required.
 - These notes are an integral part of this plan.

Drawn:	EC	Date:	22/06/17
Checked:	JG	Date:	23/06/17
Issue	Description	Date	
DRAFT	Draft plans for review	23/06/17	
ORIG	Issue to client	14/06/17	

SALES PLAN
 For Lot 742
 Providence Ripley - Stage 14

Drawing No.	Plan	Issue
116052Stage14Sales	189/742	