

Locality Diagram

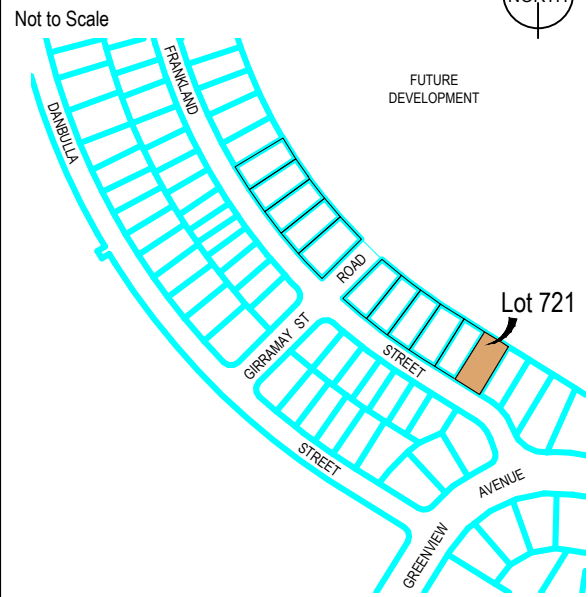

Legend

- Proposed Fence
 - Proposed Change of Grade
 - Fill Depth Contour
 - Proposed Surface Contour
 - Retaining Wall
 - Proposed Surface Level
 - Height of Wall
 - Average Height of Wall
-
- Depth of Fill 0.0m-0.5m
 - Depth of Fill 0.5m-1.0m
 - Depth of Fill 1.0m-1.5m
 - Depth of Fill 1.5m-2.0m
 - Depth of Fill 2.0m-2.5m
 - Depth of Fill 2.5m-3.0m
 - Depth of Fill 3.0m-3.5m
 - Depth of Fill 3.5m-4.0m
 - Depth of Fill 4.0m-4.5m
 - Depth of Fill 4.5m-5.0m
 - Depth of Fill 5.0m-5.5m
 - Depth of Fill 5.5m-6.0m
 - Depth of Fill 6.0m-6.5m

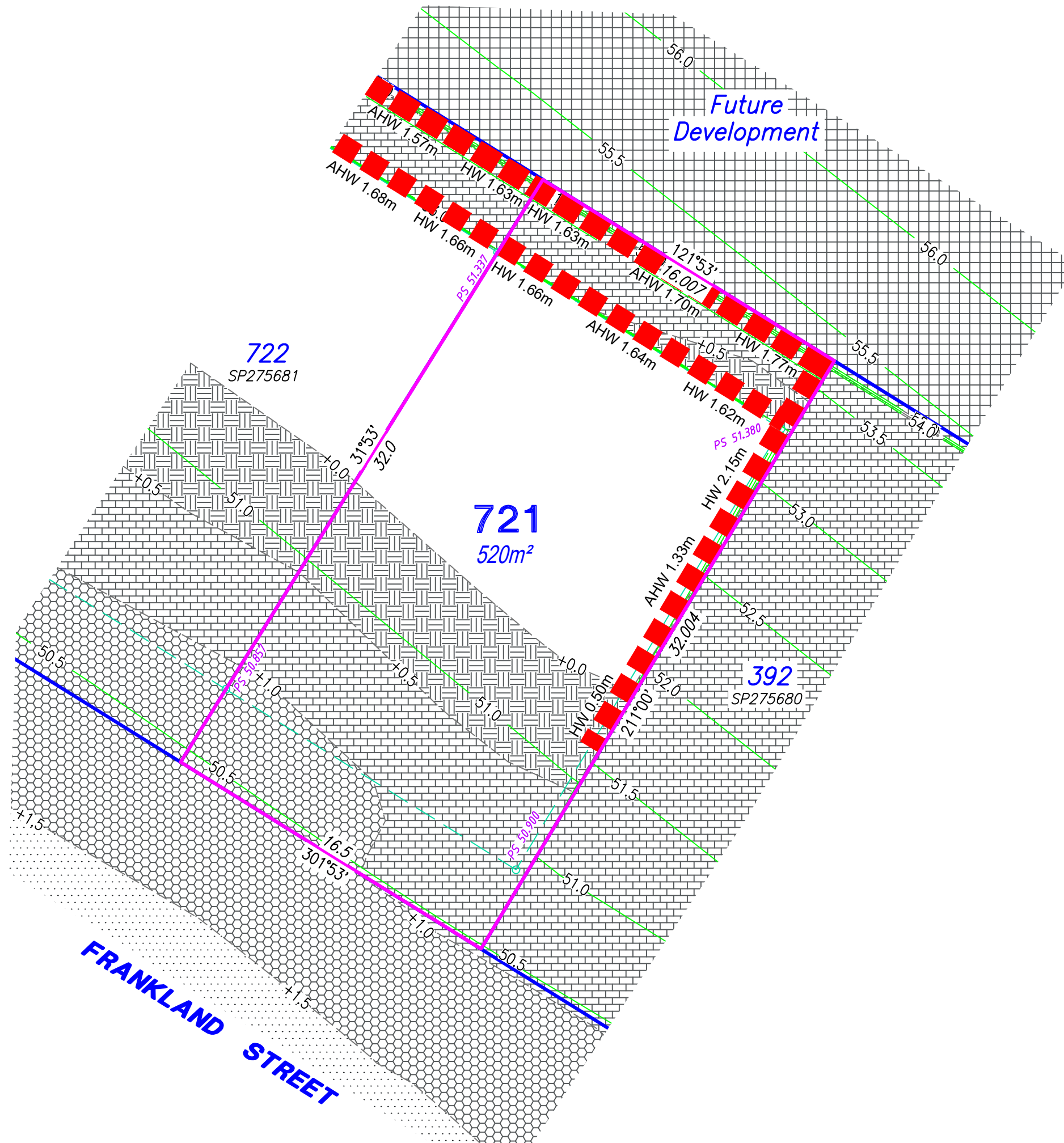

RPS
 RPS Australia East Pty Ltd
 180 Brisbane ROAD
 Ipswich Qld 4305
 t: +61 7 3437 2000
 f: +61 7 3437 2099
 www.rpsgroup.com.au

© COPYRIGHT PROTECTS THIS PLAN
 Unauthorised reproduction or amendment
 not permitted. Please contact the author.

This plan has been prepared by RPS Australia East Pty Ltd
 (Cadastral Surveyor) to satisfy the requirements of the Land Sales
 Act 1984.

CURRENTLY DESCRIBED AS:
 RPD: Lot 721 on SP275681

LOCALITY: South Ripley
 LOCAL AUTHORITY: Ipswich City Council

SCALE: 1:200 SHEET SIZE: A3

Notes

- Proposed contours and retaining wall details are compiled from the engineering design provided by Cardno (Qld) Pty Ltd, received on 20/06/2017.
- Depth of fill has been calculated from surveys compiled by RPS compared to proposed contours.
- The location of retaining walls shown are indicative only and may not represent the true width of the wall, refer to engineering drawing.
- All fill placement has been compacted under Level 1 supervision in accordance with Australian Standard AS3798-2007 'Guidelines on earthworks for commercial and residential developments'.
- Levels shown are referenced to the Australian Height Datum (AHD) vide PM60301
- Builders should not build off the design levels shown; a site survey is required.
- These notes are an integral part of this plan.

Drawn:	EC	Date:	22/06/17
Checked:	JG	Date:	23/06/17
Issue	Description	Date	
DRAFT	Draft plans for review	23/06/17	
ORIG	Issue to client	07/07/17	

SALES PLAN
 For Lot 721
 Providence Ripley - Stage 13

Drawing No.	Plan	Issue
116052Stage13Sales	190/721	

Locality Diagram

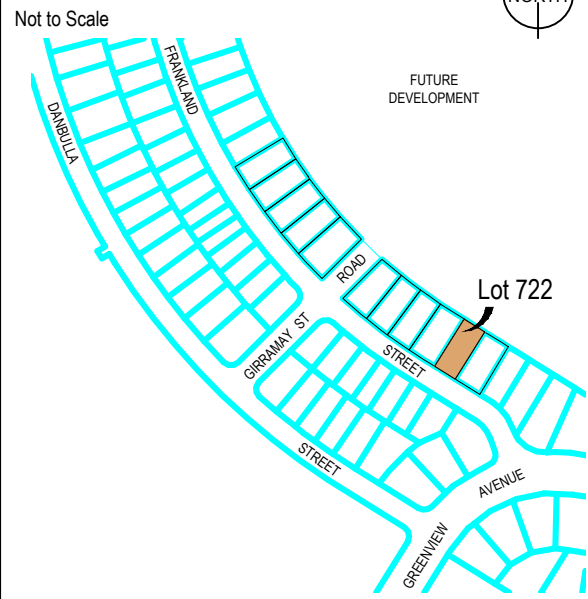

Legend

- Proposed Fence
 - Proposed Change of Grade
 - Fill Depth Contour
 - Proposed Surface Contour
 - Retaining Wall
 - Proposed Surface Level
 - Height of Wall
 - Average Height of Wall
-
- Depth of Fill 0.0m-0.5m
 - Depth of Fill 0.5m-1.0m
 - Depth of Fill 1.0m-1.5m
 - Depth of Fill 1.5m-2.0m
 - Depth of Fill 2.0m-2.5m
 - Depth of Fill 2.5m-3.0m
 - Depth of Fill 3.0m-3.5m
 - Depth of Fill 3.5m-4.0m
 - Depth of Fill 4.0m-4.5m
 - Depth of Fill 4.5m-5.0m
 - Depth of Fill 5.0m-5.5m
 - Depth of Fill 5.5m-6.0m
 - Depth of Fill 6.0m-6.5m

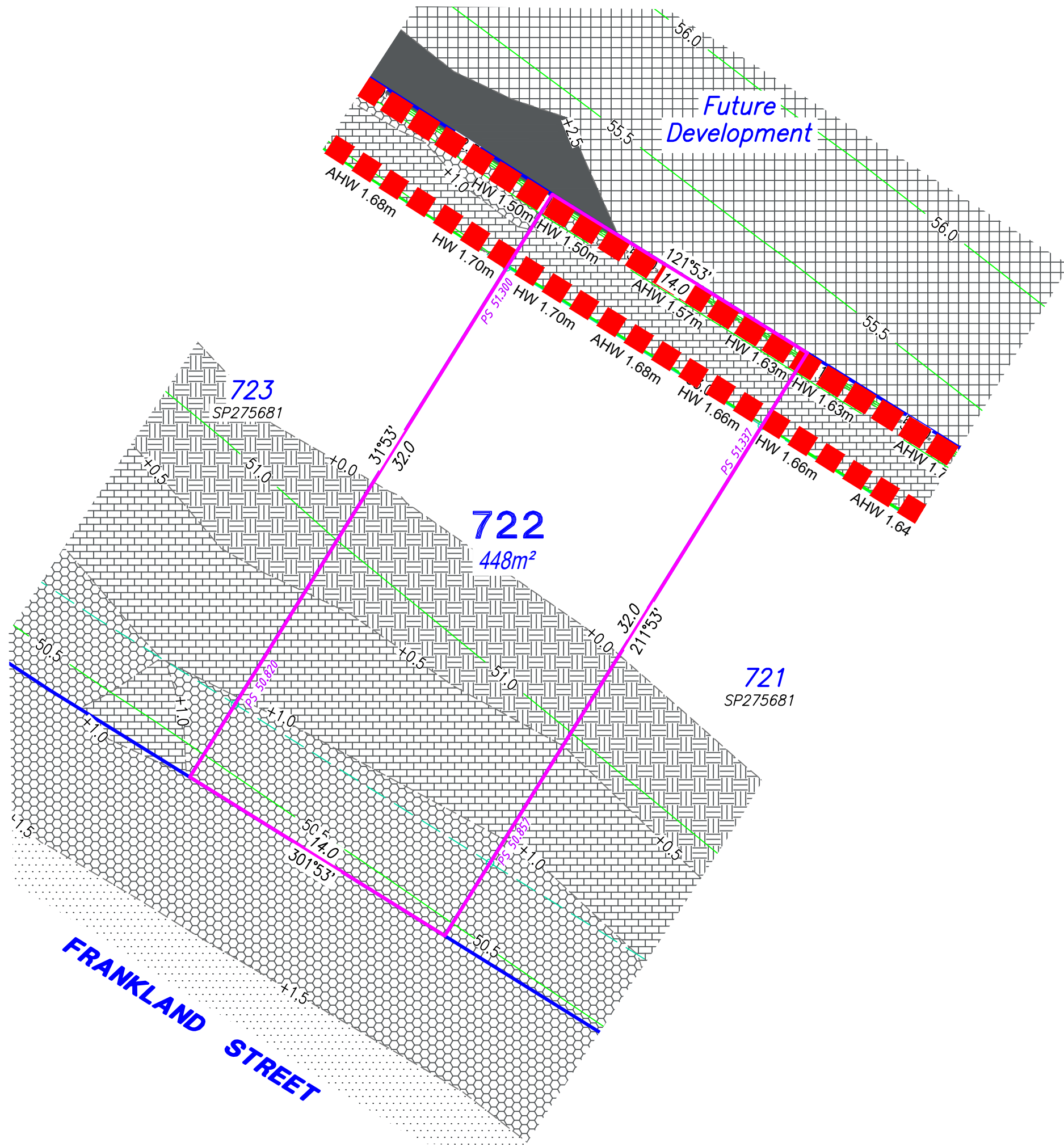

RPS
 RPS Australia East Pty Ltd
 180 Brisbane ROAD
 Ipswich Qld 4305
 t: +61 7 3437 2000
 f: +61 7 3437 2099
 www.rpsgroup.com.au

© COPYRIGHT PROTECTS THIS PLAN
 Unauthorised reproduction or amendment
 not permitted. Please contact the author.

This plan has been prepared by RPS Australia East Pty Ltd
 (Cadastral Surveyor) to satisfy the requirements of the Land Sales
 Act 1984.

CURRENTLY DESCRIBED AS:
 RPD: Lot 722 on SP275681

LOCALITY: South Ripley
 LOCAL AUTHORITY: Ipswich City Council

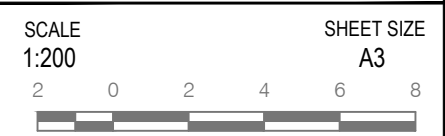

- Notes**
- Proposed contours and retaining wall details are compiled from the engineering design provided by Cardno (Qld) Pty Ltd, received on 20/06/2017.
 - Depth of fill has been calculated from surveys compiled by RPS compared to proposed contours.
 - The location of retaining walls shown are indicative only and may not represent the true width of the wall, refer to engineering drawing.
 - All fill placement has been compacted under Level 1 supervision in accordance with Australian Standard AS3798-2007 'Guidelines on earthworks for commercial and residential developments'.
 - Levels shown are referenced to the Australian Height Datum (AHD) vide PM60301
 - Builders should not build off the design levels shown; a site survey is required.
 - These notes are an integral part of this plan.

Drawn:	EC	Date:	22/06/17
Checked:	JG	Date:	23/06/17
Issue	Description	Date	
DRAFT	Draft plans for review	23/06/17	
ORIG	Issue to client	07/07/17	

SALES PLAN
 For Lot 722
 Providence Ripley - Stage 13

Drawing No.	Plan	Issue
116052Stage13Sales	190/722	

Locality Diagram

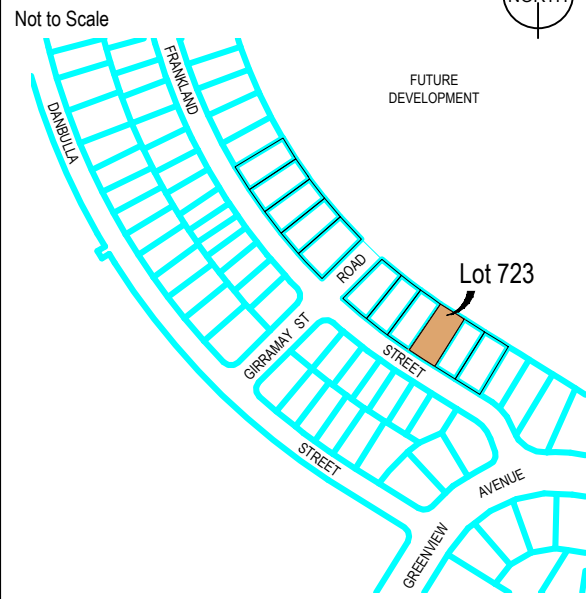

Legend

- Proposed Fence
 - Proposed Change of Grade
 - Fill Depth Contour
 - Proposed Surface Contour
 - Retaining Wall
 - Proposed Surface Level
 - Height of Wall
 - Average Height of Wall
-
- Depth of Fill 0.0m-0.5m
 - Depth of Fill 0.5m-1.0m
 - Depth of Fill 1.0m-1.5m
 - Depth of Fill 1.5m-2.0m
 - Depth of Fill 2.0m-2.5m
 - Depth of Fill 2.5m-3.0m
 - Depth of Fill 3.0m-3.5m
 - Depth of Fill 3.5m-4.0m
 - Depth of Fill 4.0m-4.5m
 - Depth of Fill 4.5m-5.0m
 - Depth of Fill 5.0m-5.5m
 - Depth of Fill 5.5m-6.0m
 - Depth of Fill 6.0m-6.5m

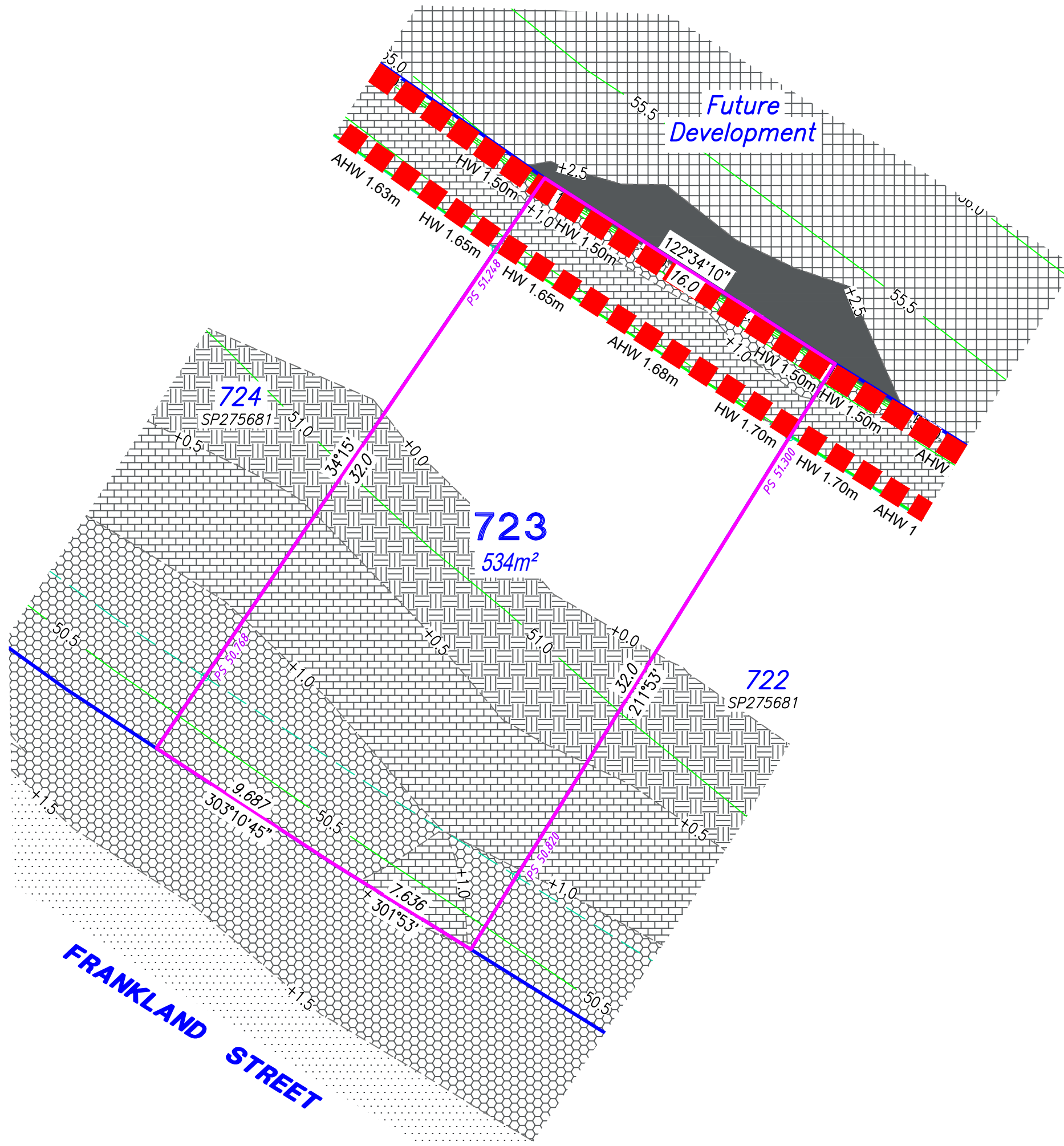

RPS
 RPS Australia East Pty Ltd
 180 Brisbane ROAD
 Ipswich Qld 4305
 t: +61 7 3437 2000
 f: +61 7 3437 2099
 www.rpsgroup.com.au

© COPYRIGHT PROTECTS THIS PLAN
 Unauthorised reproduction or amendment
 not permitted. Please contact the author.

This plan has been prepared by RPS Australia East Pty Ltd
 (Cadastral Surveyor) to satisfy the requirements of the Land Sales
 Act 1984.

CURRENTLY DESCRIBED AS:
 RPD: Lot 723 on SP275681

LOCALITY: South Ripley
 LOCAL AUTHORITY: Ipswich City Council



- Notes**
- Proposed contours and retaining wall details are compiled from the engineering design provided by Cardno (Qld) Pty Ltd, received on 20/06/2017.
 - Depth of fill has been calculated from surveys compiled by RPS compared to proposed contours.
 - The location of retaining walls shown are indicative only and may not represent the true width of the wall, refer to engineering drawing.
 - All fill placement has been compacted under Level 1 supervision in accordance with Australian Standard AS3798-2007 'Guidelines on earthworks for commercial and residential developments'.
 - Levels shown are referenced to the Australian Height Datum (AHD) vide PM60301
 - Builders should not build off the design levels shown; a site survey is required.
 - These notes are an integral part of this plan.

Drawn:	EC	Date:	22/06/17
Checked:	JG	Date:	23/06/17
Issue	Description	Date	
DRAFT	Draft plans for review	23/06/17	
ORIG	Issue to client	07/07/17	

SALES PLAN
 For Lot 723
 Providence Ripley - Stage 13

Drawing No.	Plan	Issue
116052Stage13Sales	190/723	

Locality Diagram

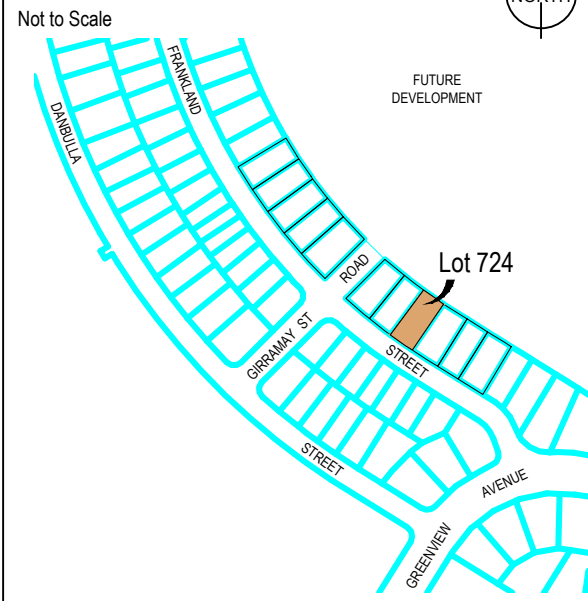

Legend

- Proposed Fence
 - Proposed Change of Grade
 - Fill Depth Contour
 - Proposed Surface Contour
 - Retaining Wall
 - Proposed Surface Level
 - Height of Wall
 - Average Height of Wall
-
- Depth of Fill 0.0m-0.5m
 - Depth of Fill 0.5m-1.0m
 - Depth of Fill 1.0m-1.5m
 - Depth of Fill 1.5m-2.0m
 - Depth of Fill 2.0m-2.5m
 - Depth of Fill 2.5m-3.0m
 - Depth of Fill 3.0m-3.5m
 - Depth of Fill 3.5m-4.0m
 - Depth of Fill 4.0m-4.5m
 - Depth of Fill 4.5m-5.0m
 - Depth of Fill 5.0m-5.5m
 - Depth of Fill 5.5m-6.0m
 - Depth of Fill 6.0m-6.5m

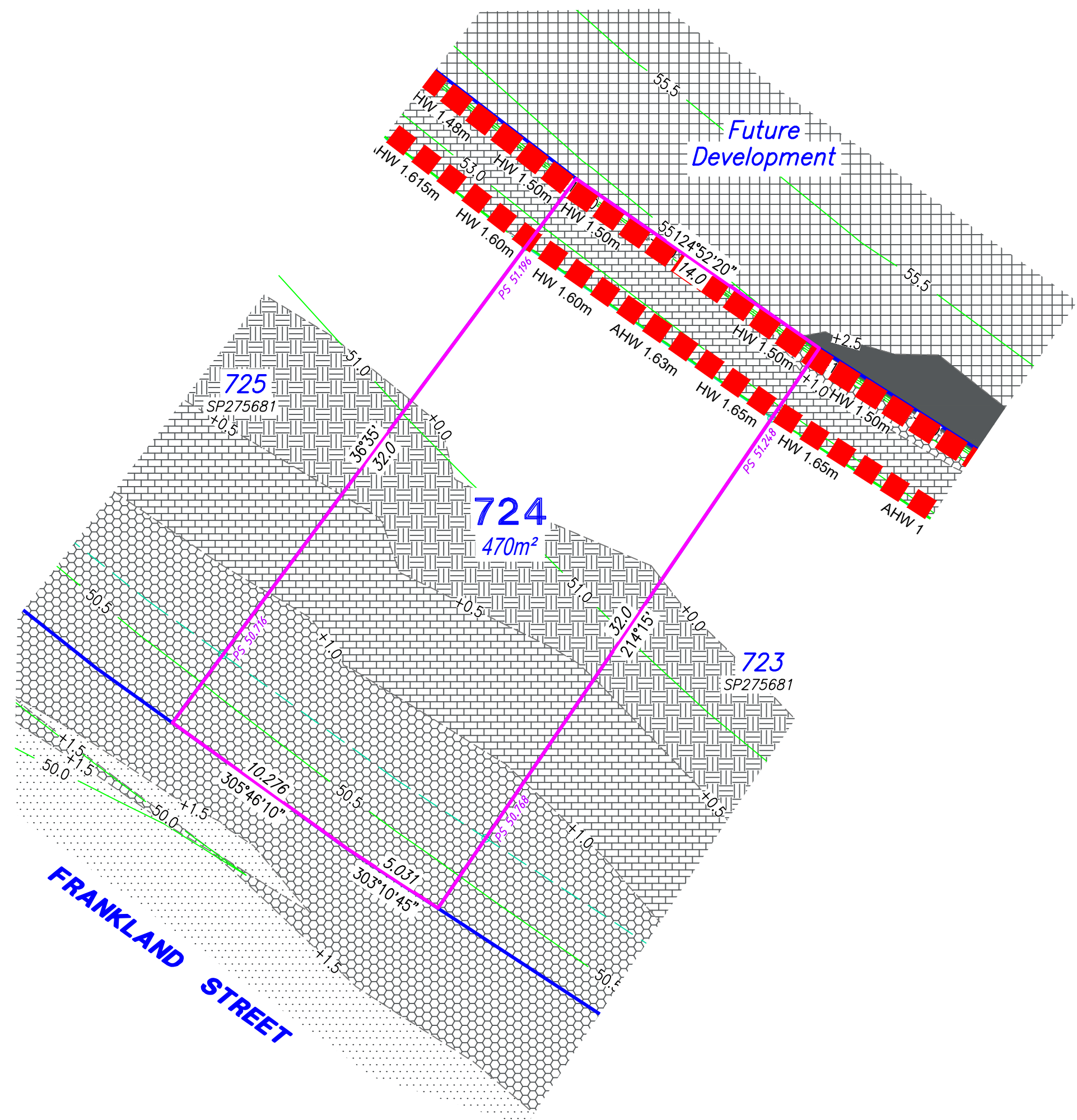

RPS
 RPS Australia East Pty Ltd
 180 Brisbane ROAD
 Ipswich Qld 4305
 t: +61 7 3437 2000
 f: +61 7 3437 2099
 www.rpsgroup.com.au

© COPYRIGHT PROTECTS THIS PLAN
 Unauthorised reproduction or amendment
 not permitted. Please contact the author.

This plan has been prepared by RPS Australia East Pty Ltd
 (Cadastral Surveyor) to satisfy the requirements of the Land Sales
 Act 1984.

CURRENTLY DESCRIBED AS:
 RPD: Lot 724 on SP275681

LOCALITY: South Ripley
 LOCAL AUTHORITY: Ipswich City Council

SCALE: 1:200 SHEET SIZE: A3

- Notes**
- Proposed contours and retaining wall details are compiled from the engineering design provided by Cardno (Qld) Pty Ltd, received on 20/06/2017.
 - Depth of fill has been calculated from surveys compiled by RPS compared to proposed contours.
 - The location of retaining walls shown are indicative only and may not represent the true width of the wall, refer to engineering drawing.
 - All fill placement has been compacted under Level 1 supervision in accordance with Australian Standard AS3798-2007 'Guidelines on earthworks for commercial and residential developments'.
 - Levels shown are referenced to the Australian Height Datum (AHD) vide PM60301
 - Builders should not build off the design levels shown; a site survey is required.
 - These notes are an integral part of this plan.

Drawn:	EC	Date:	22/06/17
Checked:	JG	Date:	23/06/17
Issue	Description	Date	
DRAFT	Draft plans for review	23/06/17	
ORIG	Issue to client	07/07/17	

SALES PLAN
 For Lot 724
 Providence Ripley - Stage 13

Drawing No.	Plan	Issue
116052Stage13Sales	190/724	

Locality Diagram

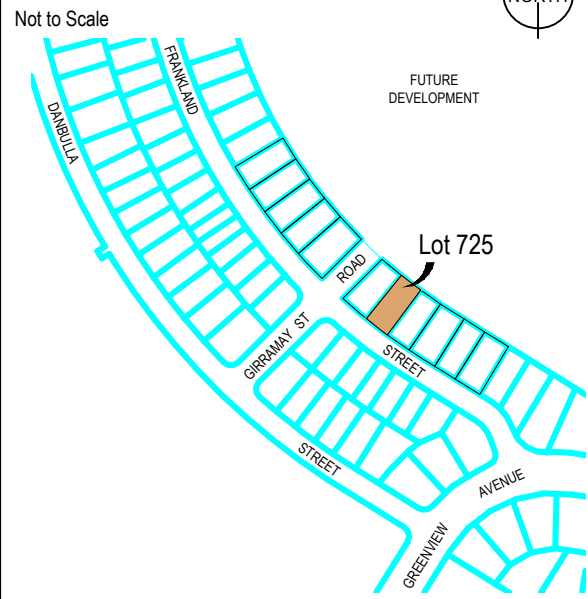

Legend

- Proposed Fence
 - Proposed Change of Grade
 - Fill Depth Contour
 - Proposed Surface Contour
 - Retaining Wall
 - Proposed Surface Level
 - Height of Wall
 - Average Height of Wall
-
- Depth of Fill 0.0m-0.5m
 - Depth of Fill 0.5m-1.0m
 - Depth of Fill 1.0m-1.5m
 - Depth of Fill 1.5m-2.0m
 - Depth of Fill 2.0m-2.5m
 - Depth of Fill 2.5m-3.0m
 - Depth of Fill 3.0m-3.5m
 - Depth of Fill 3.5m-4.0m
 - Depth of Fill 4.0m-4.5m
 - Depth of Fill 4.5m-5.0m
 - Depth of Fill 5.0m-5.5m
 - Depth of Fill 5.5m-6.0m
 - Depth of Fill 6.0m-6.5m

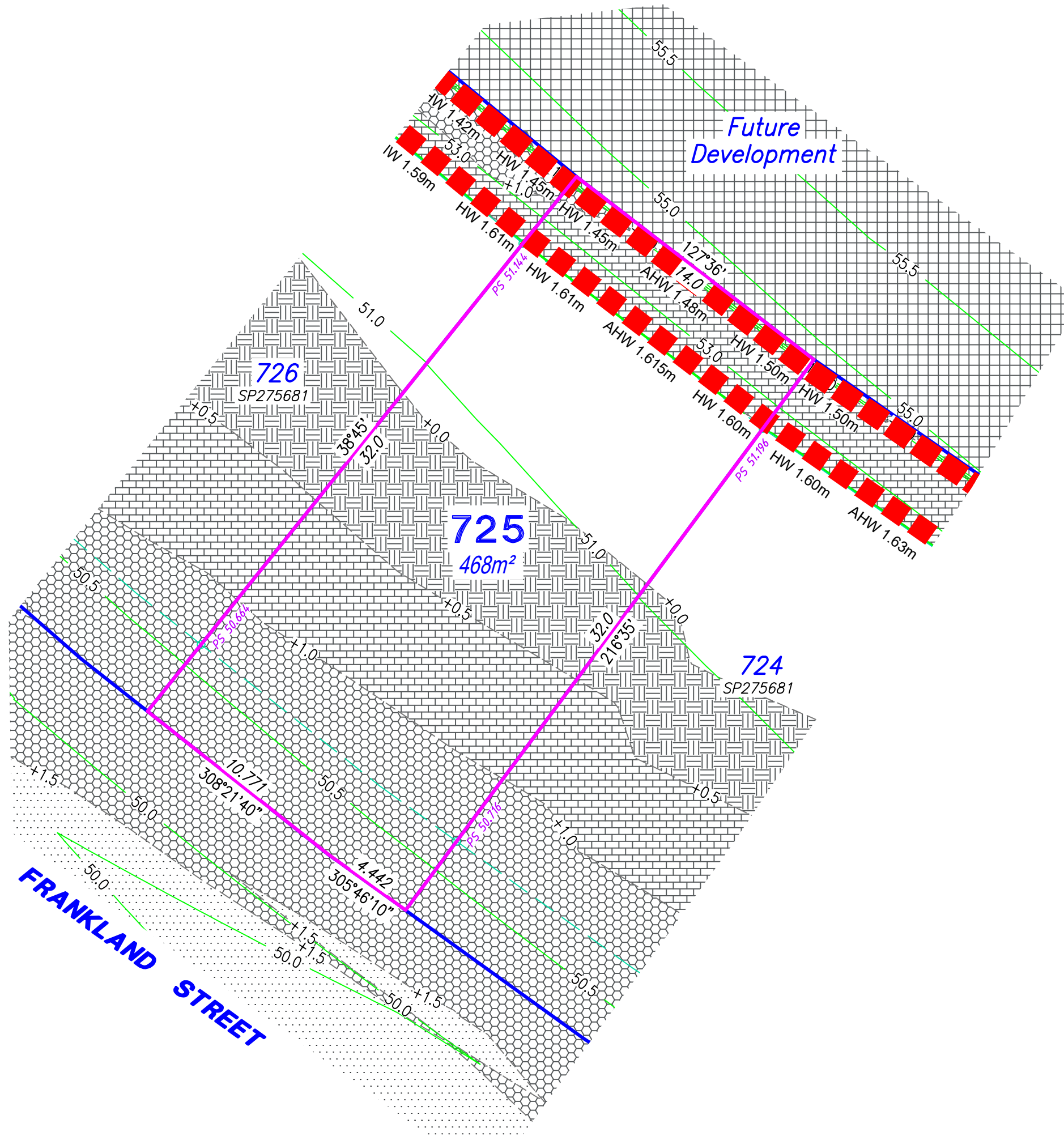

RPS Australia East Pty Ltd
 180 Brisbane ROAD
 Ipswich Qld 4305
 t: +61 7 3437 2000
 f: +61 7 3437 2099
 www.rpsgroup.com.au

© COPYRIGHT PROTECTS THIS PLAN
 Unauthorised reproduction or amendment
 not permitted. Please contact the author.

This plan has been prepared by RPS Australia East Pty Ltd
 (Cadastral Surveyor) to satisfy the requirements of the Land Sales
 Act 1984.

CURRENTLY DESCRIBED AS:
 RPD: Lot 725 on SP275681

LOCALITY: South Ripley
 LOCAL AUTHORITY: Ipswich City Council

SCALE: 1:200 SHEET SIZE: A3

Notes

- Proposed contours and retaining wall details are compiled from the engineering design provided by Cardno (Qld) Pty Ltd, received on 20/06/2017.
- Depth of fill has been calculated from surveys compiled by RPS compared to proposed contours.
- The location of retaining walls shown are indicative only and may not represent the true width of the wall, refer to engineering drawing.
- All fill placement has been compacted under Level 1 supervision in accordance with Australian Standard AS3798-2007 'Guidelines on earthworks for commercial and residential developments'.
- Levels shown are referenced to the Australian Height Datum (AHD) vide PM60301
- Builders should not build off the design levels shown; a site survey is required.
- These notes are an integral part of this plan.

Drawn:	EC	Date:	22/06/17
Checked:	JG	Date:	23/06/17
Issue	Description	Date	
DRAFT	Draft plans for review	23/06/17	
ORIG	Issue to client	07/07/17	

SALES PLAN
 For Lot 725
 Providence Ripley - Stage 13

Drawing No.	Plan	Issue
116052Stage13Sales	190/725	

Locality Diagram

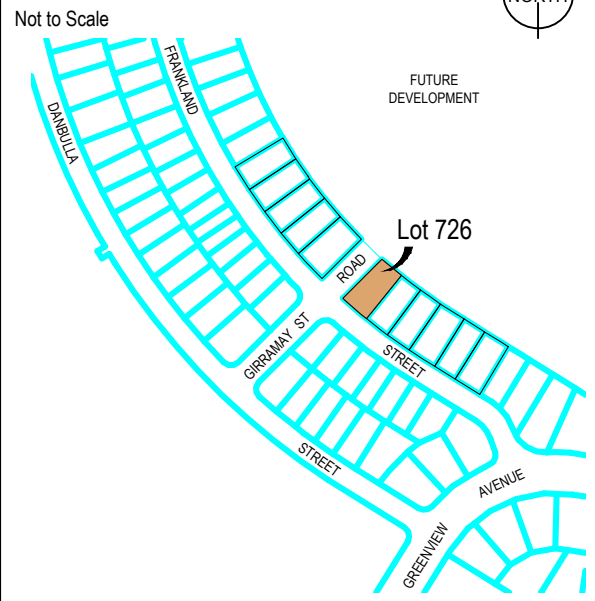

Legend

- Proposed Fence
 - Proposed Change of Grade
 - Fill Depth Contour
 - Proposed Surface Contour
 - Retaining Wall
 - Proposed Surface Level
 - Height of Wall
 - Average Height of Wall
-
- Depth of Fill 0.0m-0.5m
 - Depth of Fill 0.5m-1.0m
 - Depth of Fill 1.0m-1.5m
 - Depth of Fill 1.5m-2.0m
 - Depth of Fill 2.0m-2.5m
 - Depth of Fill 2.5m-3.0m
 - Depth of Fill 3.0m-3.5m
 - Depth of Fill 3.5m-4.0m
 - Depth of Fill 4.0m-4.5m
 - Depth of Fill 4.5m-5.0m
 - Depth of Fill 5.0m-5.5m
 - Depth of Fill 5.5m-6.0m
 - Depth of Fill 6.0m-6.5m

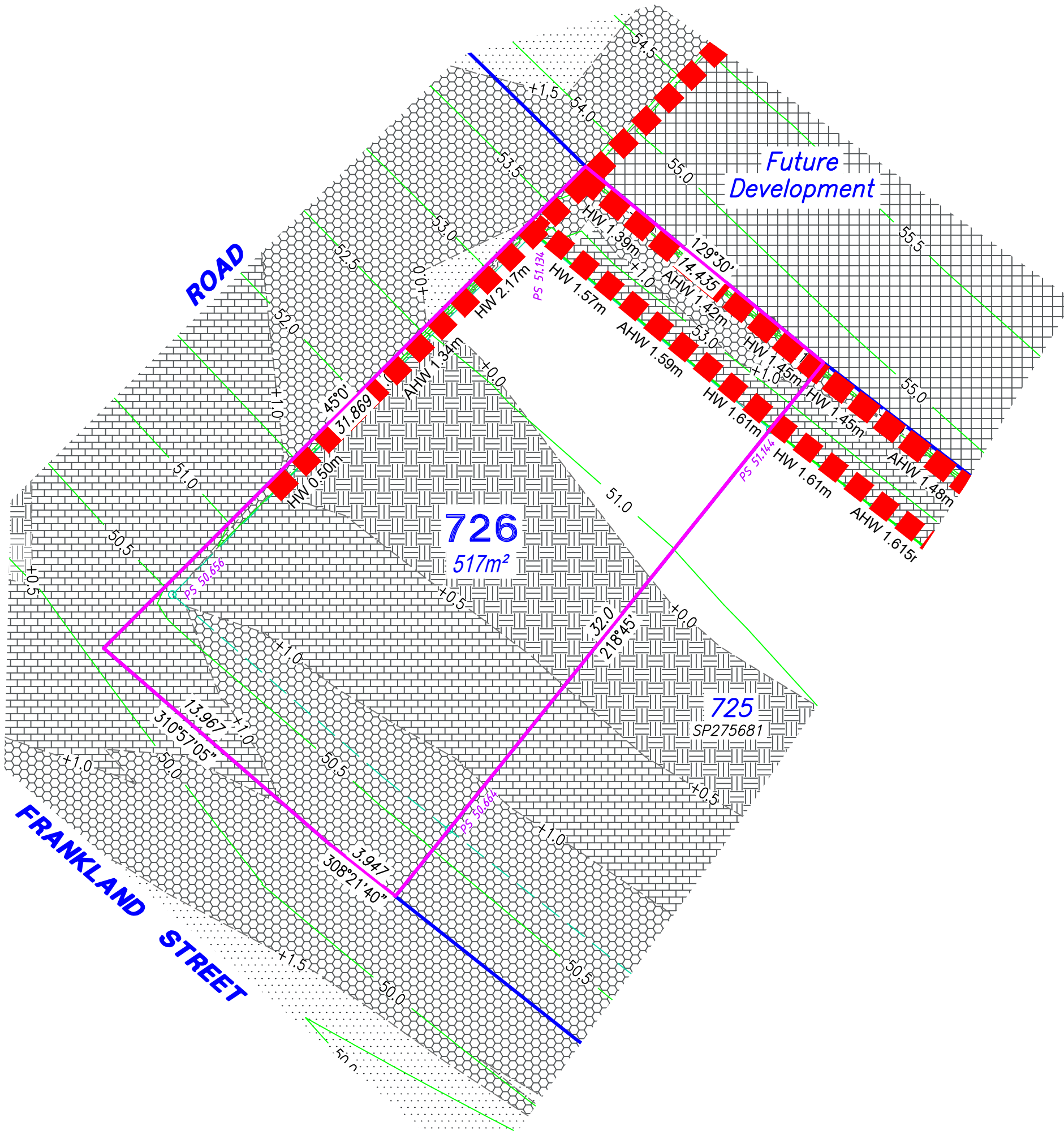

RPS Australia East Pty Ltd
 180 Brisbane ROAD
 Ipswich Qld 4305
 t: +61 7 3437 2000
 f: +61 7 3437 2099
 www.rpsgroup.com.au

© COPYRIGHT PROTECTS THIS PLAN
 Unauthorised reproduction or amendment
 not permitted. Please contact the author.

This plan has been prepared by RPS Australia East Pty Ltd
 (Cadastral Surveyor) to satisfy the requirements of the Land Sales
 Act 1984.

CURRENTLY DESCRIBED AS:
 RP: Lot 726 on SP275681

LOCALITY: South Ripley
 LOCAL AUTHORITY: Ipswich City Council



- Notes**
- Proposed contours and retaining wall details are compiled from the engineering design provided by Cardno (Qld) Pty Ltd, received on 20/06/2017.
 - Depth of fill has been calculated from surveys compiled by RPS compared to proposed contours.
 - The location of retaining walls shown are indicative only and may not represent the true width of the wall, refer to engineering drawing.
 - All fill placement has been compacted under Level 1 supervision in accordance with Australian Standard AS3798-2007 'Guidelines on earthworks for commercial and residential developments'.
 - Levels shown are referenced to the Australian Height Datum (AHD) vide PM60301
 - Builders should not build off the design levels shown; a site survey is required.
 - These notes are an integral part of this plan.

Drawn:	EC	Date:	22/06/17
Checked:	JG	Date:	23/06/17
Issue	Description	Date	
DRAFT	Draft plans for review	23/06/17	
ORIG	Issue to client	07/07/17	

SALES PLAN
 For Lot 726
 Providence Ripley - Stage 13

Drawing No.	Plan	Issue
116052Stage13Sales	190/726	

Locality Diagram

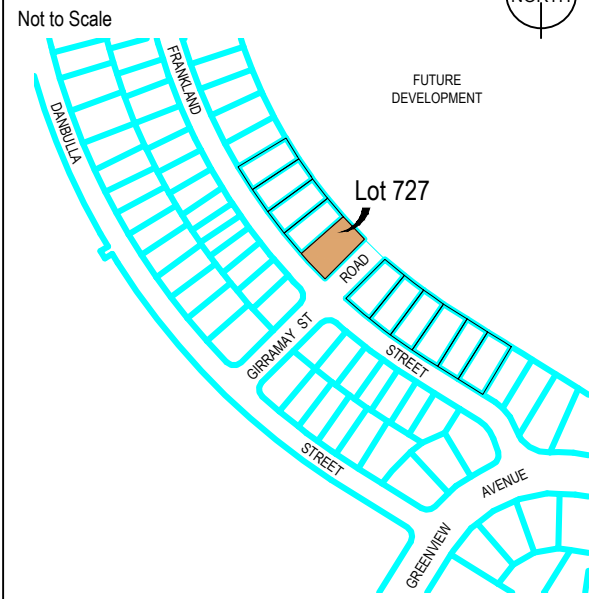

Legend

- Proposed Fence
 - Proposed Change of Grade
 - Fill Depth Contour
 - Proposed Surface Contour
 - Retaining Wall
 - Proposed Surface Level
 - Height of Wall
 - Average Height of Wall
-
- Depth of Fill 0.0m-0.5m
 - Depth of Fill 0.5m-1.0m
 - Depth of Fill 1.0m-1.5m
 - Depth of Fill 1.5m-2.0m
 - Depth of Fill 2.0m-2.5m
 - Depth of Fill 2.5m-3.0m
 - Depth of Fill 3.0m-3.5m
 - Depth of Fill 3.5m-4.0m
 - Depth of Fill 4.0m-4.5m
 - Depth of Fill 4.5m-5.0m
 - Depth of Fill 5.0m-5.5m
 - Depth of Fill 5.5m-6.0m
 - Depth of Fill 6.0m-6.5m

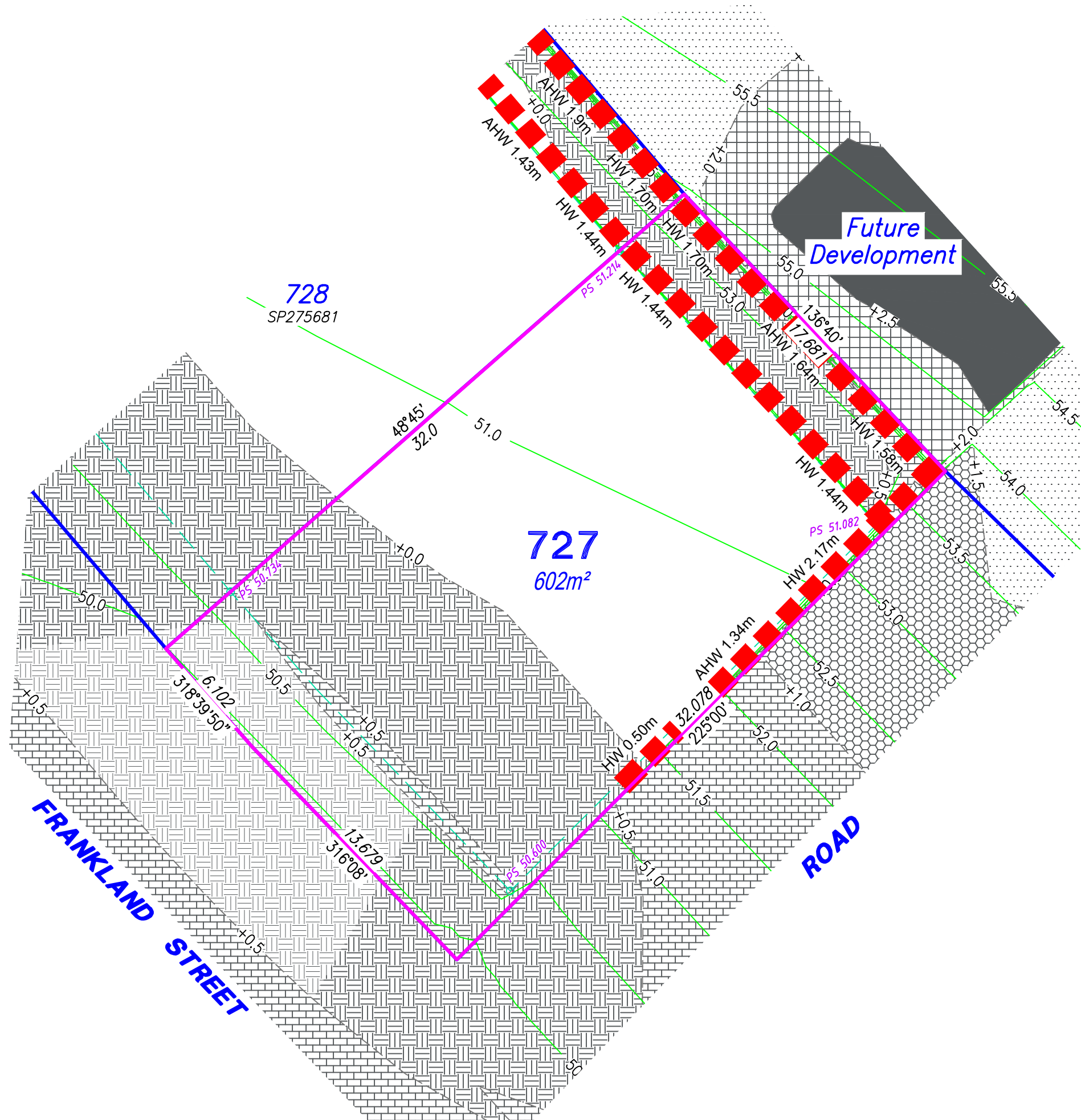

RPS
 RPS Australia East Pty Ltd
 180 Brisbane ROAD
 Ipswich Qld 4305
 t: +61 7 3437 2000
 f: +61 7 3437 2099
 www.rpsgroup.com.au

© COPYRIGHT PROTECTS THIS PLAN
 Unauthorised reproduction or amendment
 not permitted. Please contact the author.

This plan has been prepared by RPS Australia East Pty Ltd
 (Cadastral Surveyor) to satisfy the requirements of the Land Sales
 Act 1984.

CURRENTLY DESCRIBED AS:
 RPD: Lot 727 on SP275681

LOCALITY: South Ripley
 LOCAL AUTHORITY: Ipswich City Council



- Notes**
- Proposed contours and retaining wall details are compiled from the engineering design provided by Cardno (Qld) Pty Ltd, received on 20/06/2017.
 - Depth of fill has been calculated from surveys compiled by RPS compared to proposed contours.
 - The location of retaining walls shown are indicative only and may not represent the true width of the wall, refer to engineering drawing.
 - All fill placement has been compacted under Level 1 supervision in accordance with Australian Standard AS3798-2007 'Guidelines on earthworks for commercial and residential developments'.
 - Levels shown are referenced to the Australian Height Datum (AHD) vide PM60301
 - Builders should not build off the design levels shown; a site survey is required.
 - These notes are an integral part of this plan.

Drawn:	EC	Date:	22/06/17
Checked:	JG	Date:	23/06/17
Issue	Description	Date	
DRAFT	Draft plans for review	23/06/17	
ORIG	Issue to client	07/07/17	

SALES PLAN
 For Lot 727
 Providence Ripley - Stage 13

Drawing No.	Plan	Issue
116052Stage13Sales	190/727	

Locality Diagram

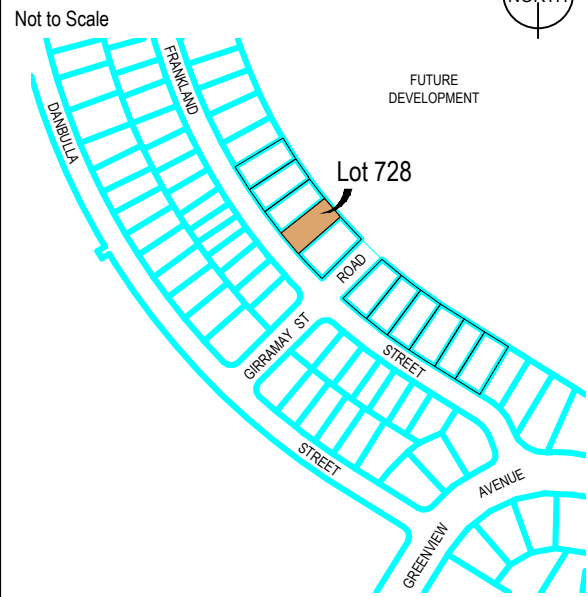

Legend

- Proposed Fence
 - Proposed Change of Grade
 - Fill Depth Contour
 - Proposed Surface Contour
 - Retaining Wall
 - Proposed Surface Level
 - Height of Wall
 - Average Height of Wall
-
- Depth of Fill 0.0m-0.5m
 - Depth of Fill 0.5m-1.0m
 - Depth of Fill 1.0m-1.5m
 - Depth of Fill 1.5m-2.0m
 - Depth of Fill 2.0m-2.5m
 - Depth of Fill 2.5m-3.0m
 - Depth of Fill 3.0m-3.5m
 - Depth of Fill 3.5m-4.0m
 - Depth of Fill 4.0m-4.5m
 - Depth of Fill 4.5m-5.0m
 - Depth of Fill 5.0m-5.5m
 - Depth of Fill 5.5m-6.0m
 - Depth of Fill 6.0m-6.5m

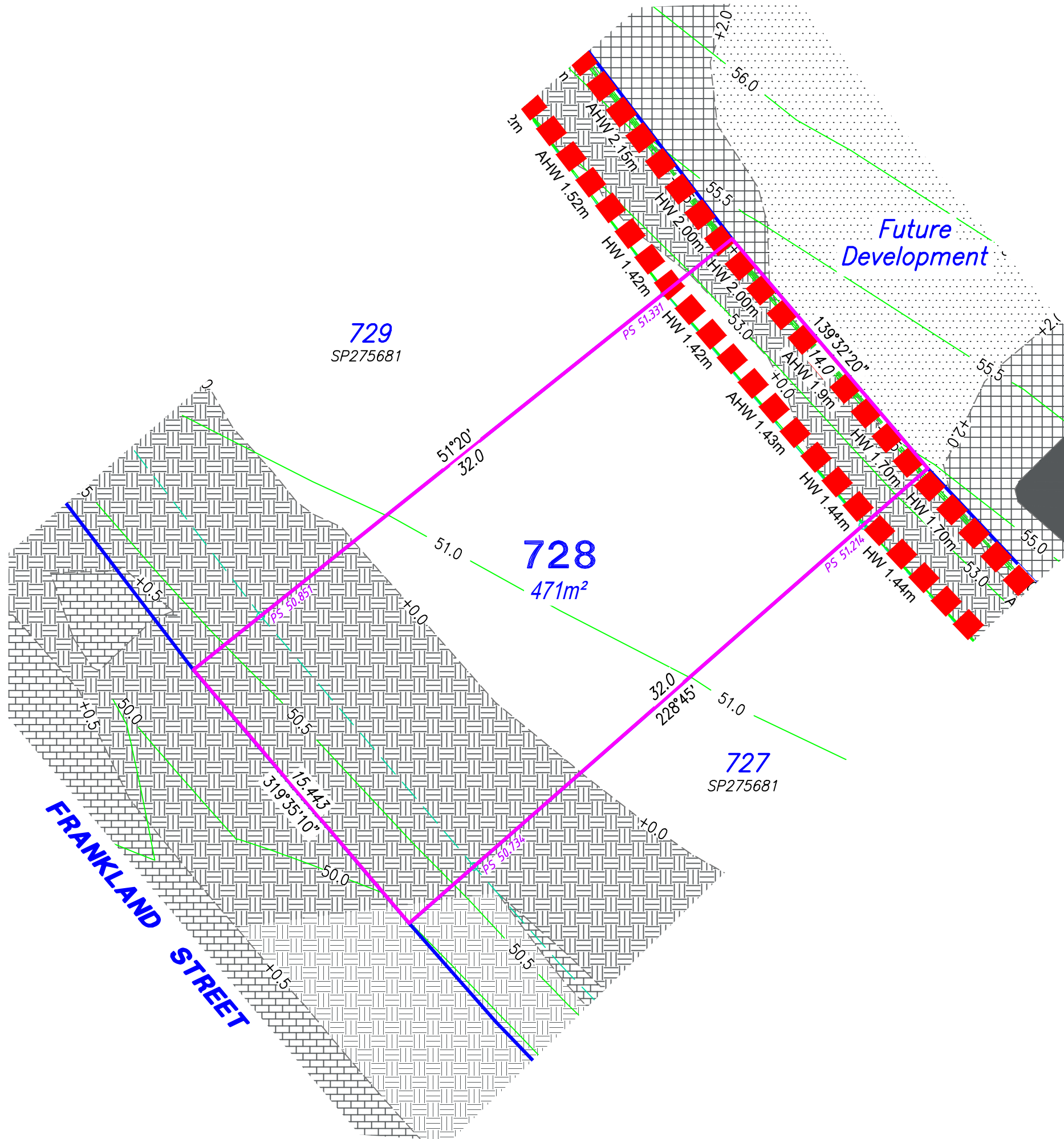

RPS Australia East Pty Ltd
 180 Brisbane ROAD
 Ipswich Qld 4305
 t: +61 7 3437 2000
 f: +61 7 3437 2099
 www.rpsgroup.com.au

© COPYRIGHT PROTECTS THIS PLAN
 Unauthorised reproduction or amendment
 not permitted. Please contact the author.

This plan has been prepared by RPS Australia East Pty Ltd
 (Cadastral Surveyor) to satisfy the requirements of the Land Sales
 Act 1984.

CURRENTLY DESCRIBED AS:
 RPD: Lot 728 on SP275681

LOCALITY: South Ripley
 LOCAL AUTHORITY: Ipswich City Council



- Notes**
- Proposed contours and retaining wall details are compiled from the engineering design provided by Cardno (Qld) Pty Ltd, received on 20/06/2017.
 - Depth of fill has been calculated from surveys compiled by RPS compared to proposed contours.
 - The location of retaining walls shown are indicative only and may not represent the true width of the wall, refer to engineering drawing.
 - All fill placement has been compacted under Level 1 supervision in accordance with Australian Standard AS3798-2007 'Guidelines on earthworks for commercial and residential developments'.
 - Levels shown are referenced to the Australian Height Datum (AHD) vide PM60301
 - Builders should not build off the design levels shown; a site survey is required.
 - These notes are an integral part of this plan.

Drawn:	EC	Date:	22/06/17
Checked:	JG	Date:	23/06/17
Issue	Description	Date	
DRAFT	Draft plans for review	23/06/17	
ORIG	Issue to client	07/07/17	

SALES PLAN
 For Lot 728
 Providence Ripley - Stage 13

Drawing No.	Plan	Issue
116052Stage13Sales	190/728	

Locality Diagram

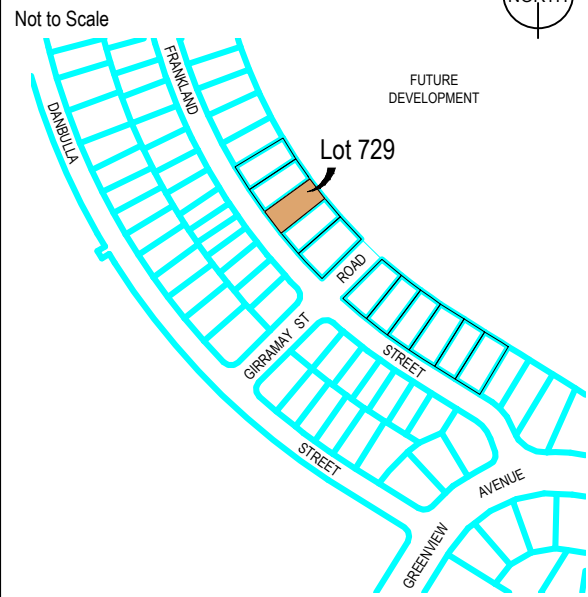

Legend

- Proposed Fence
 - Proposed Change of Grade
 - Fill Depth Contour
 - Proposed Surface Contour
 - Retaining Wall
 - Proposed Surface Level
 - Height of Wall
 - Average Height of Wall
-
- Depth of Fill 0.0m-0.5m
 - Depth of Fill 0.5m-1.0m
 - Depth of Fill 1.0m-1.5m
 - Depth of Fill 1.5m-2.0m
 - Depth of Fill 2.0m-2.5m
 - Depth of Fill 2.5m-3.0m
 - Depth of Fill 3.0m-3.5m
 - Depth of Fill 3.5m-4.0m
 - Depth of Fill 4.0m-4.5m
 - Depth of Fill 4.5m-5.0m
 - Depth of Fill 5.0m-5.5m
 - Depth of Fill 5.5m-6.0m
 - Depth of Fill 6.0m-6.5m

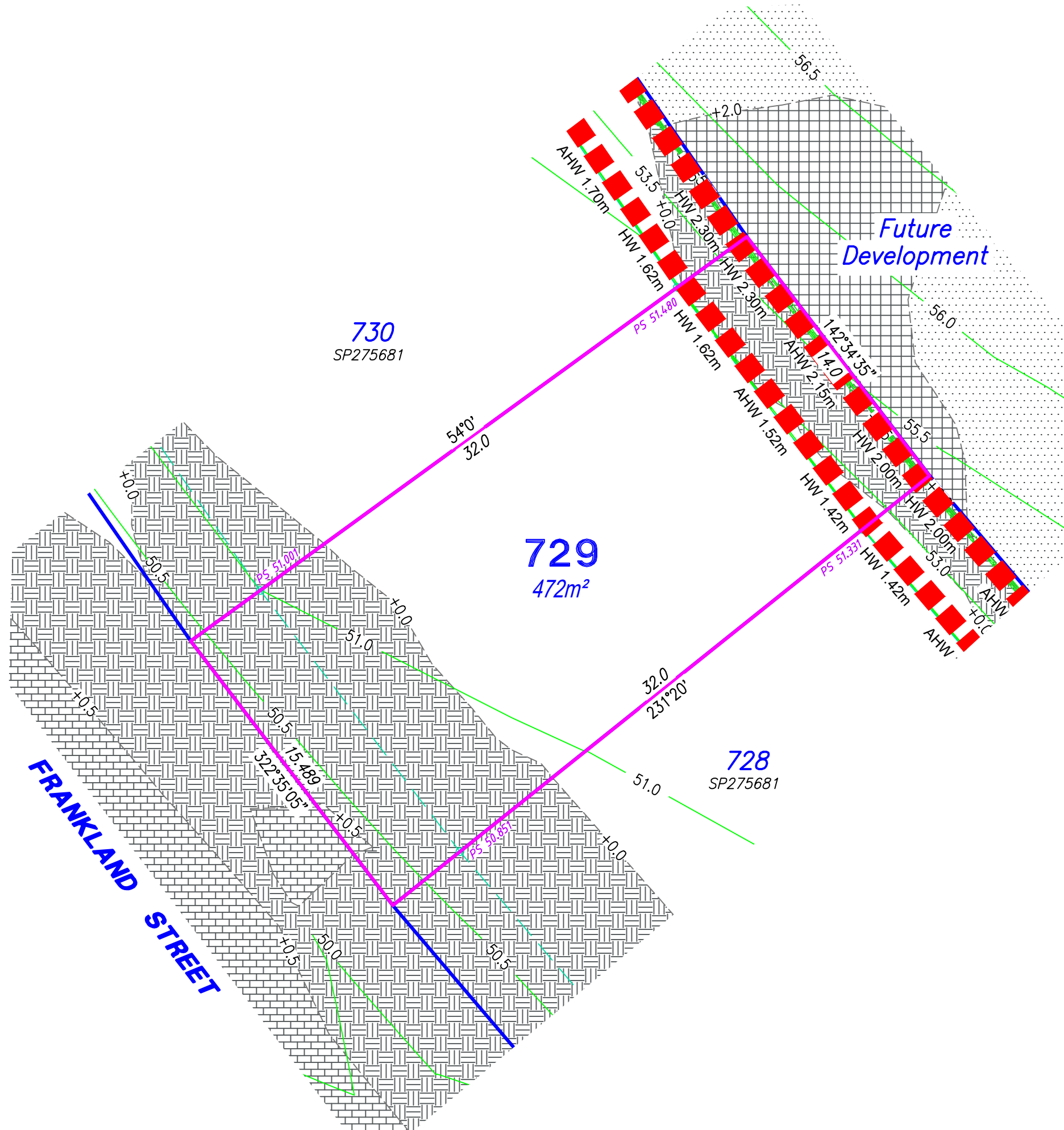

RPS Australia East Pty Ltd
 180 Brisbane ROAD
 Ipswich Qld 4305
 t: +61 7 3437 2000
 f: +61 7 3437 2099
 www.rpsgroup.com.au

© COPYRIGHT PROTECTS THIS PLAN
 Unauthorised reproduction or amendment
 not permitted. Please contact the author.

This plan has been prepared by RPS Australia East Pty Ltd
 (Cadastral Surveyor) to satisfy the requirements of the Land Sales
 Act 1984.

CURRENTLY DESCRIBED AS:
 RPD: Lot 729 on SP275681

LOCALITY: South Ripley
 LOCAL AUTHORITY: Ipswich City Council



- Notes**
- Proposed contours and retaining wall details are compiled from the engineering design provided by Cardno (Qld) Pty Ltd, received on 20/06/2017.
 - Depth of fill has been calculated from surveys compiled by RPS compared to proposed contours.
 - The location of retaining walls shown are indicative only and may not represent the true width of the wall, refer to engineering drawing.
 - All fill placement has been compacted under Level 1 supervision in accordance with Australian Standard AS3798-2007 'Guidelines on earthworks for commercial and residential developments'.
 - Levels shown are referenced to the Australian Height Datum (AHD) vide PM60301
 - Builders should not build off the design levels shown; a site survey is required.
 - These notes are an integral part of this plan.

Drawn:	EC	Date:	22/06/17
Checked:	JG	Date:	23/06/17
Issue	Description	Date	
DRAFT	Draft plans for review	23/06/17	
ORIG	Issue to client	07/07/17	

SALES PLAN
 For Lot 729
 Providence Ripley - Stage 13

Drawing No.	Plan	Issue
116052Stage13Sales	190/729	

Locality Diagram

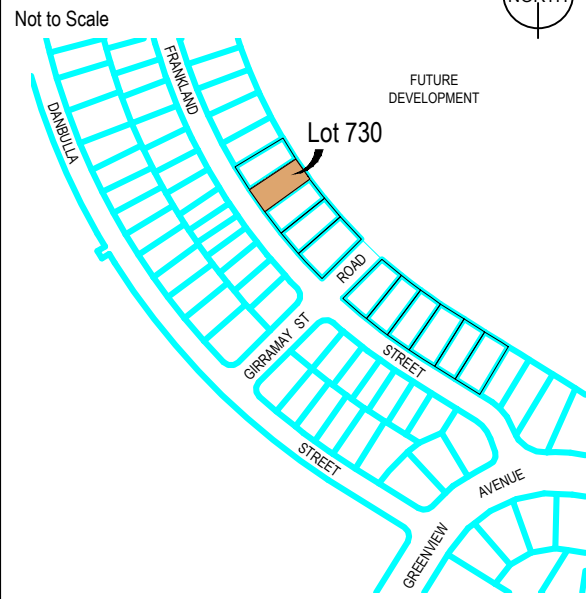

Legend

- Proposed Fence
 - Proposed Change of Grade
 - Fill Depth Contour
 - Proposed Surface Contour
 - Retaining Wall
 - Proposed Surface Level
 - Height of Wall
 - Average Height of Wall
-
- Depth of Fill 0.0m-0.5m
 - Depth of Fill 0.5m-1.0m
 - Depth of Fill 1.0m-1.5m
 - Depth of Fill 1.5m-2.0m
 - Depth of Fill 2.0m-2.5m
 - Depth of Fill 2.5m-3.0m
 - Depth of Fill 3.0m-3.5m
 - Depth of Fill 3.5m-4.0m
 - Depth of Fill 4.0m-4.5m
 - Depth of Fill 4.5m-5.0m
 - Depth of Fill 5.0m-5.5m
 - Depth of Fill 5.5m-6.0m
 - Depth of Fill 6.0m-6.5m

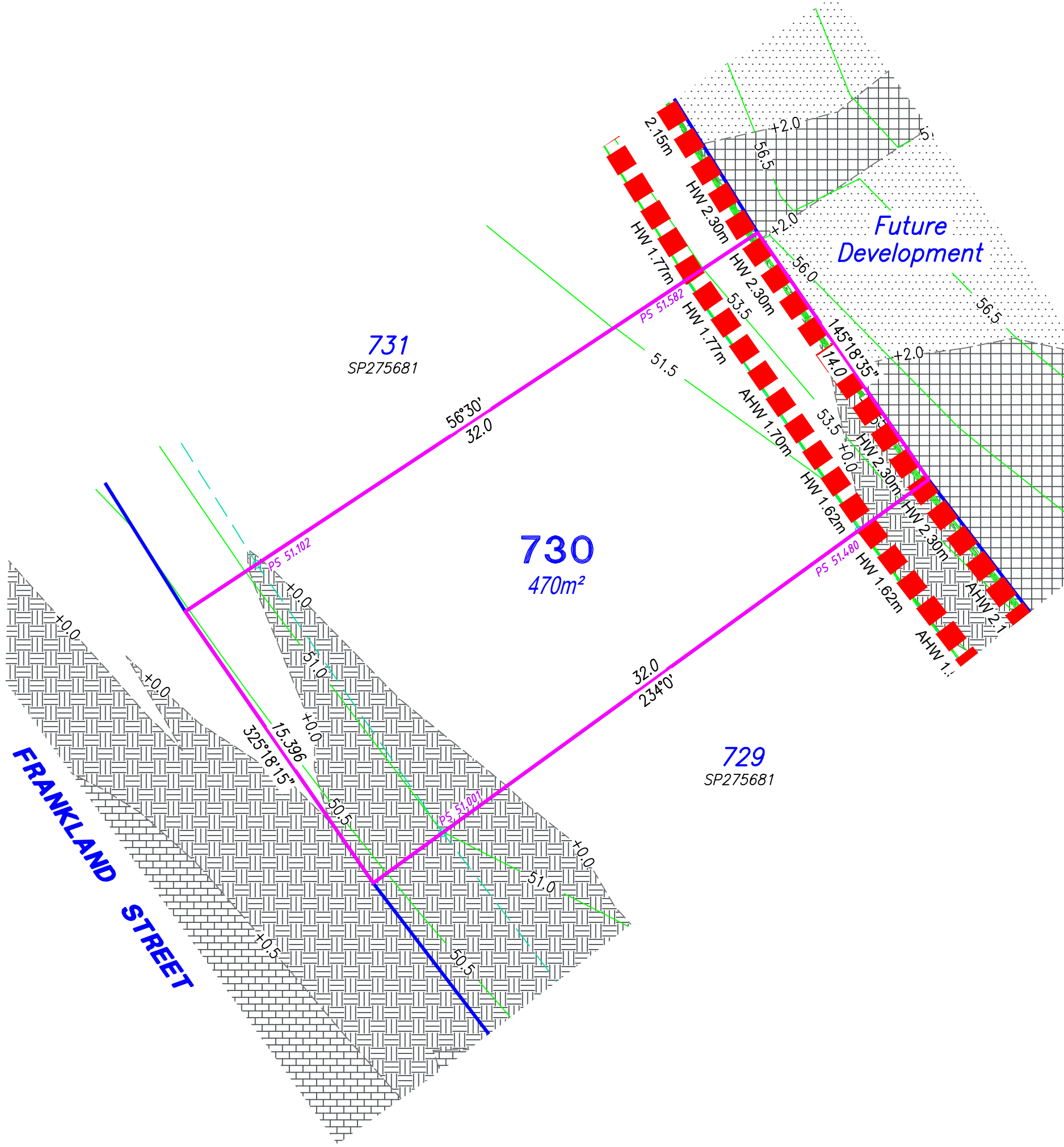

RPS Australia East Pty Ltd
 180 Brisbane ROAD
 Ipswich Qld 4305
 t: +61 7 3437 2000
 f: +61 7 3437 2099
 www.rpsgroup.com.au

© COPYRIGHT PROTECTS THIS PLAN
 Unauthorised reproduction or amendment
 not permitted. Please contact the author.

This plan has been prepared by RPS Australia East Pty Ltd
 (Cadastral Surveyor) to satisfy the requirements of the Land Sales
 Act 1984.

CURRENTLY DESCRIBED AS:
 RPD: Lot 730 on SP275681

LOCALITY: South Ripley
 LOCAL AUTHORITY: Ipswich City Council

SCALE 1:200 SHEET SIZE A3

- Notes**
- Proposed contours and retaining wall details are compiled from the engineering design provided by Cardno (Qld) Pty Ltd, received on 20/06/2017.
 - Depth of fill has been calculated from surveys compiled by RPS compared to proposed contours.
 - The location of retaining walls shown are indicative only and may not represent the true width of the wall, refer to engineering drawing.
 - All fill placement has been compacted under Level 1 supervision in accordance with Australian Standard AS3798-2007 'Guidelines on earthworks for commercial and residential developments'.
 - Levels shown are referenced to the Australian Height Datum (AHD) vide PM60301
 - Builders should not build off the design levels shown; a site survey is required.
 - These notes are an integral part of this plan.

Drawn:	EC	Date:	22/06/17
Checked:	JG	Date:	23/06/17
Issue	Description	Date	
DRAFT	Draft plans for review	23/06/17	
ORIG	Issue to client	07/07/17	

SALES PLAN
 For Lot 730
 Providence Ripley - Stage 13

Drawing No.	Plan	Issue
116052Stage13Sales	190/730	

Locality Diagram

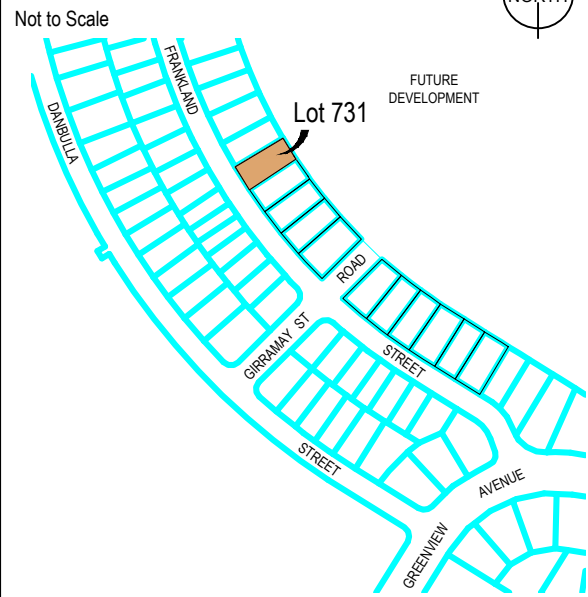

Legend

- Proposed Fence
 - Proposed Change of Grade
 - Fill Depth Contour
 - Proposed Surface Contour
 - Retaining Wall
 - Proposed Surface Level
 - Height of Wall
 - Average Height of Wall
-
- Depth of Fill 0.0m-0.5m
 - Depth of Fill 0.5m-1.0m
 - Depth of Fill 1.0m-1.5m
 - Depth of Fill 1.5m-2.0m
 - Depth of Fill 2.0m-2.5m
 - Depth of Fill 2.5m-3.0m
 - Depth of Fill 3.0m-3.5m
 - Depth of Fill 3.5m-4.0m
 - Depth of Fill 4.0m-4.5m
 - Depth of Fill 4.5m-5.0m
 - Depth of Fill 5.0m-5.5m
 - Depth of Fill 5.5m-6.0m
 - Depth of Fill 6.0m-6.5m

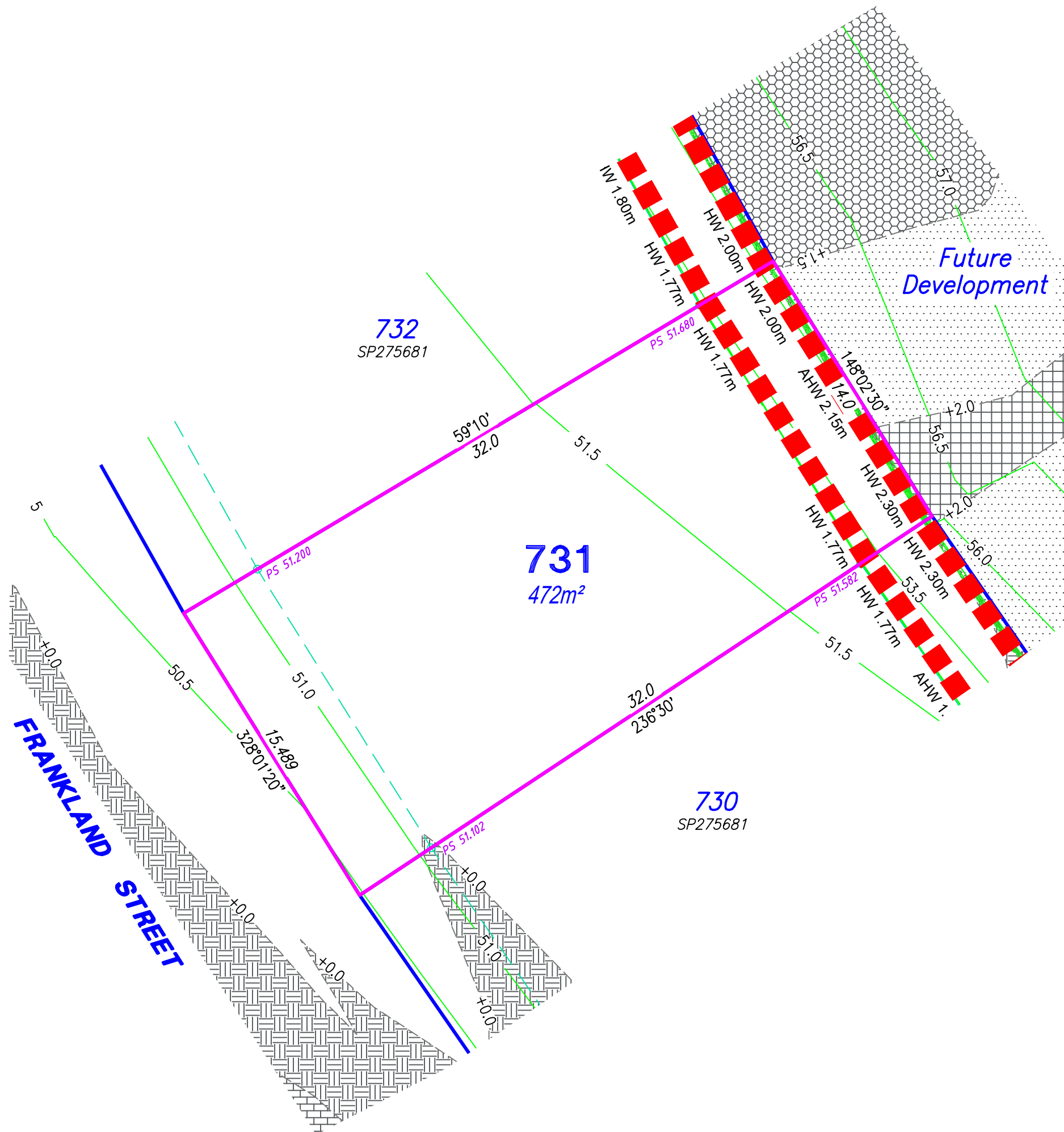

RPS Australia East Pty Ltd
 180 Brisbane ROAD
 Ipswich Qld 4305
 t: +61 7 3437 2000
 f: +61 7 3437 2099
 www.rpsgroup.com.au

© COPYRIGHT PROTECTS THIS PLAN
 Unauthorised reproduction or amendment
 not permitted. Please contact the author.

This plan has been prepared by RPS Australia East Pty Ltd
 (Cadastral Surveyor) to satisfy the requirements of the Land Sales
 Act 1984.

CURRENTLY DESCRIBED AS:
 RPD: Lot 731 on SP275681

LOCALITY: South Ripley
 LOCAL AUTHORITY: Ipswich City Council

SCALE 1:200 SHEET SIZE A3

- Notes**
- Proposed contours and retaining wall details are compiled from the engineering design provided by Cardno (Qld) Pty Ltd, received on 20/06/2017.
 - Depth of fill has been calculated from surveys compiled by RPS compared to proposed contours.
 - The location of retaining walls shown are indicative only and may not represent the true width of the wall, refer to engineering drawing.
 - All fill placement has been compacted under Level 1 supervision in accordance with Australian Standard AS3798-2007 'Guidelines on earthworks for commercial and residential developments'.
 - Levels shown are referenced to the Australian Height Datum (AHD) vide PM60301
 - Builders should not build off the design levels shown; a site survey is required.
 - These notes are an integral part of this plan.

Drawn:	EC	Date:	22/06/17
Checked:	JG	Date:	23/06/17
Issue	Description	Date	
DRAFT	Draft plans for review	23/06/17	
ORIG	Issue to client	07/07/17	

SALES PLAN
 For Lot 731
 Providence Ripley - Stage 13

Drawing No. 116052Stage13Sales	Plan 190/731	Issue
-----------------------------------	-----------------	-------