

DATE PLOTTED: 15 February 2016 4:58 PM BY: JAMES MARTIN

XREFS: X:790400-013-014-ROADS & DRAIN; X:790400-013-SEW & WAT; X:790400-014-DRAINAGE; X:790400-013-DRAINAGE; X:790400-013-014-CONTS - PROP  
CAD File: L:\7904-00 ARP Subdivision\013 - 13-14 - DESIGN Drawings\790400-013-SK-011.dwg

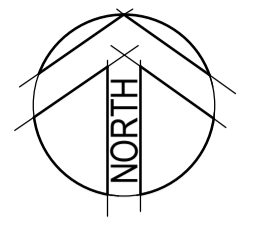

CENTENARY HIGHWAY EXTENSION

- LEGEND**
- SWD PROPOSED STORMWATER SERVICES
  - W PROPOSED WATER SERVICES
  - S PROPOSED SEWER SERVICES
  - SWD EXISTING STORMWATER SERVICES
  - W EXISTING WATER SERVICES
  - S EXISTING SEWER SERVICES
  - RETAINING WALL
  - LOT BUILT TO BOUNDARY
  - \* STREETLIGHT
  - UNDERGROUND ELECTRICAL CROSS STREET CONDUIT
  - ELECTRICITY PILLAR

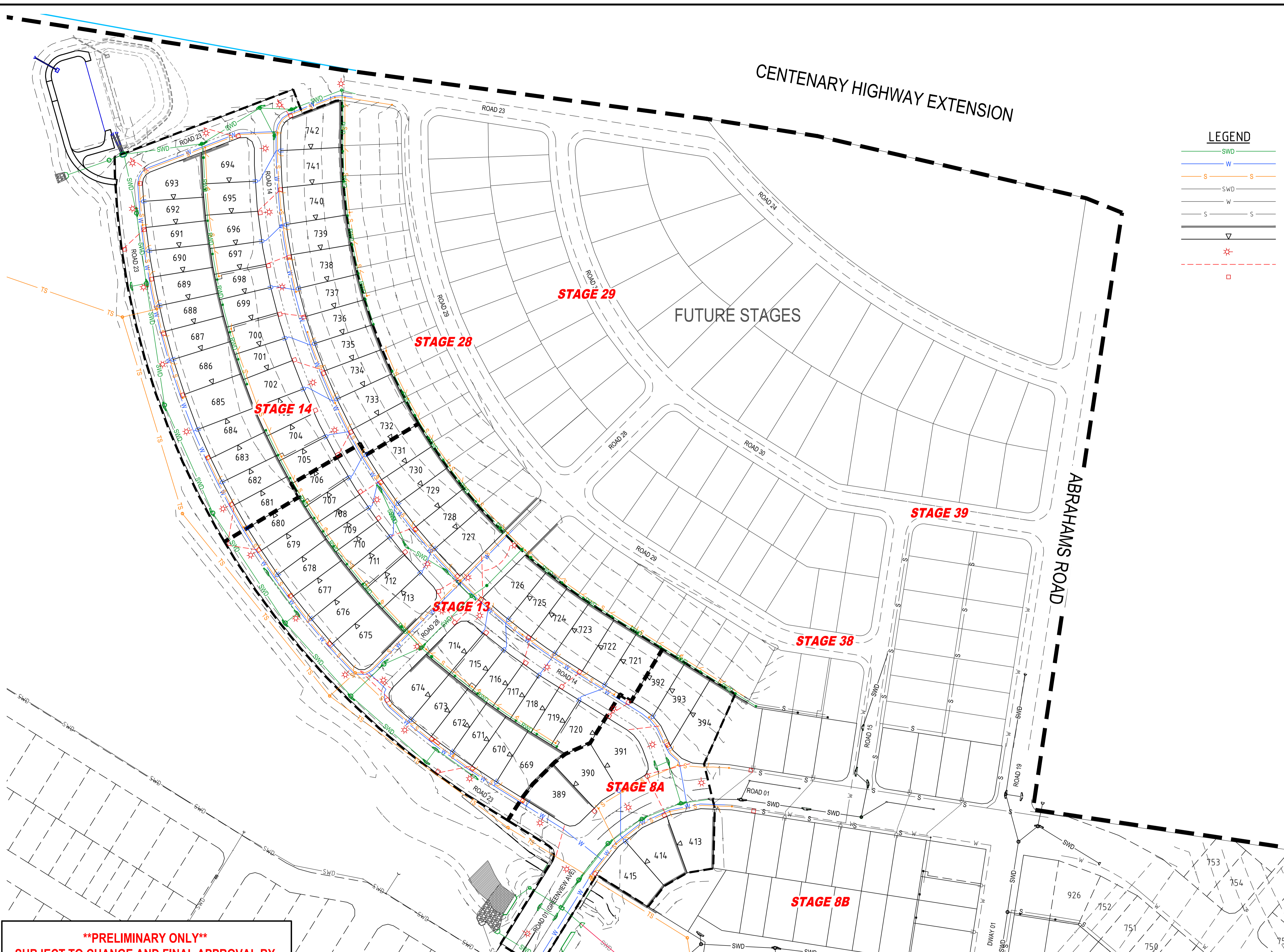

**\*\*PRELIMINARY ONLY\*\***  
**SUBJECT TO CHANGE AND FINAL APPROVAL BY RELEVANT AUTHORITIES. LOCATION OF SERVICES MAY CHANGE - BUILDERS MUST CONFIRM FINAL LOCATION PRIOR TO SITING HOME.**  
**\*\*IF IN DOUBT ASK, DO NOT ASSUME\*\***

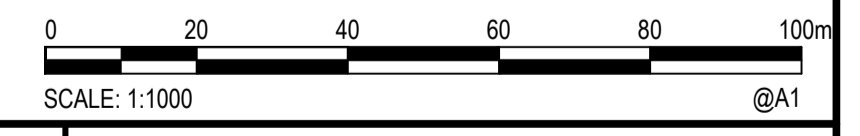

© Cardno Limited All Rights Reserved.  
 This document is produced by Cardno Limited solely for the benefit of and use by the client in accordance with the terms of the retainer. Cardno Limited does not and shall not assume any responsibility or liability whatsoever to any third party arising out of any use or reliance by third party on the content of this document.

**Cardno**  
 Shaping the Future

Cardno (Qld) Pty Ltd | ABN 57 051 074 992  
 Level 11, 515 St Paul's Terrace  
 Fortitude Valley, QLD 4006  
 Tel: 07 3369 9822 Fax: 07 3369 9722  
 Web: www.cardno.com.au

AMEX CORPORATION PTY LTD			
STAGE 13-14 COMBINED SERVICES LAYOUT			
Date	Scale	Size	
14/04/2015	1:1000	A1	
Drawing Number	Revision		
790400-013-SK-011			3